

THE ORCHARDS AT DIMPLE DELL

LOCATED IN THE NORTHWEST QUARTER OF SECTION 14,
TOWNSHIP 3 SOUTH, RANGE 1 EAST,
SALT LAKE BASE AND MERIDIAN
SANDY CITY, SALT LAKE COUNTY, UTAH
PRELIMINARY PLAT

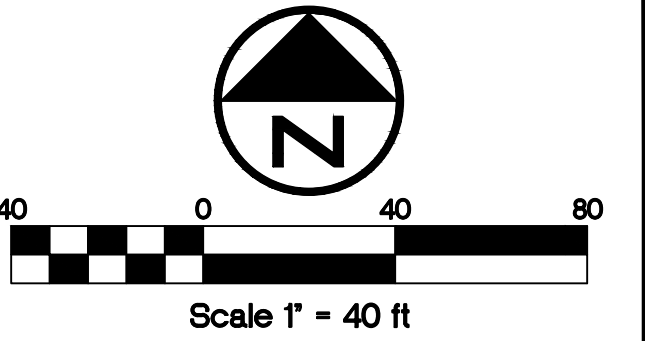

BASIS OF BEARINGS
N89°02'20"E 2667.55' (MEAS)
1374.18' (TIE)

NORTHWEST CORNER OF SECTION 14,
TOWNSHIP 3 SOUTH, RANGE 1 EAST,
SALT LAKE BASE AND MERIDIAN
(FOUND BRASS CAP MONUMENT)
BENCHMARK=5074.52 (NAVD88, GEOID18)
N: 7374994.76
E: 1552863.11

Curve #	Length	Radius	Delta	Chord Bearing	Chord Distance
C1	94.70'	197.00'	27°32'29"	N13°45'53"E	93.79'
C2	91.02'	183.00'	28°29'48"	S13°17'14"W	90.08'
C3	59.40'	282.00'	12°04'10"	S05°04'25"W	59.29'
C4	44.92'	218.00'	11°48'20"	N05°12'20"E	44.84'
C5	136.00'	276.00'	28°13'59"	S76°34'51"E	134.63'
C6	81.76'	171.00'	27°23'47"	N13°50'15"E	80.99'
C7	103.95'	209.00'	28°29'48"	N13°17'14"W	102.88'
C8	3.00'	209.00'	0°49'21"	N27°07'28"E	3.00'
C9	100.95'	209.00'	27°40'27"	N12°52'34"E	99.97'
C10	19.68'	35.00'	32°13'16"	N15°08'58"E	19.42'
C11	156.34'	58.00'	15°42'32"	S45°57'40"E	113.13'
C12	37.07'	58.00'	36°37'02"	S12°57'05"W	36.44'
C13	59.74'	58.00'	59°00'42"	S34°51'47"E	57.13'
C14	59.54'	58.00'	58°48'48"	N86°13'28"E	56.96'
C15	19.68'	35.00'	32°13'16"	N72°55'42"E	19.42'
C16	8.97'	35.00'	14°40'43"	N64°09'25"E	8.94'
C17	10.72'	35.00'	17°32'34"	N80°16'03"E	10.67'
C18	19.68'	35.00'	32°13'16"	S74°51'02"E	19.42'
C19	156.34'	58.00'	15°42'32"	N44°02'20"E	113.13'
C20	33.18'	58.00'	32°46'44"	S75°07'46"E	32.73'
C21	84.83'	58.00'	83°47'59"	N46°34'53"E	77.47'
C22	38.33'	58.00'	37°51'50"	N14°15'01"W	37.64'
C23	19.68'	35.00'	32°13'16"	S17°04'18"E	19.42'
C24	53.93'	256.00'	12°04'10"	N05°04'25"E	53.83'
C25	25.50'	256.00'	5°42'27"	N01°53'34"E	25.49'
C26	28.42'	256.00'	6°21'42"	N07°55'39"E	28.41'
C27	50.28'	244.00'	11°48'20"	N05°12'20"E	50.19'
C28	5.51'	244.00'	1°17'37"	N10°27'41"E	5.51'
C29	44.77'	244.00'	10°30'44"	N04°33'31"E	44.70'
C30	23.56'	15.00'	90°00'00"	S44°18'09"W	21.21'
C31	23.14'	15.00'	88°23'11"	N46°30'15"W	20.91'
C32	23.58'	15.00'	90°03'23"	N43°09'35"E	21.23'
C33	122.03'	441.87'	15°49'25"	N05°39'45"E	121.65'
C34	123.19'	250.00'	28°13'59"	N76°34'51"W	121.95'
C35	4.96'	250.00'	1°08'11"	S89°52'15"W	4.96'
C36	118.23'	250.00'	27°05'48"	N76°00'46"W	117.13'
C37	21.79'	15.00'	83°14'53"	S20°50'26"E	19.93'
C38	81.35'	223.00'	20°54'03"	N10°19'59"E	80.90'
C39	23.56'	15.00'	90°00'00"	S72°32'08"W	21.21'
C40	78.09'	157.00'	28°29'48"	S13°17'14"W	77.28'
C41	26.60'	157.00'	9°42'24"	N22°40'56"E	26.57'
C42	51.49'	157.00'	18°47'24"	N08°26'02"E	51.26'
C43	23.56'	15.00'	90°00'00"	S45°57'40"E	21.21'
C44	23.56'	15.00'	90°00'00"	N44°02'20"E	21.21'
C45	64.88'	308.00'	12°04'10"	N05°04'25"E	64.76'
C46	32.41'	308.00'	6°01'44"	N08°05'38"E	32.39'
C47	32.47'	308.00'	6°02'25"	N02°03'33"E	32.46'
C48	23.56'	15.00'	90°00'00"	N45°41'51"W	21.21'
C49	148.81'	302.00'	28°13'59"	N76°34'51"W	147.31'
C50	54.05'	302.00'	10°15'16"	N85°34'13"W	53.98'
C51	94.76'	302.00'	17°58'43"	N71°27'13"W	94.37'



LEGEND

	SECTION LINE
	FOUND SECTION CORNER
	ROW CENTERLINE
	NEW STREET MONUMENT PER SLCO STANDARDS AND SPECS
	SET 5/8 REBAR AND CAP (BOUNDARY LINE)
	(WILDING ENGINEERING) OR PLUG AT LOT LINE EXTENSION
	ADJACENT PROPERTY / ROW LINE
	PUBLIC UTILITY AND DRAINAGE EASEMENT
	EASEMENT LINE
	LOT LINE

- NOTES:**
1. WILDING ENGINEERING WILL SET REBAR AND CAPS AT ALL REAR LOT CORNERS.
 2. PLUG WILL BE SET IN THE TOP BACK OF CURB FOR FRONT LOT CORNERS REPRESENTING AN EXTENSION OF SIDE LOT LINES.
 3. ALL COORDINATES SHOWN ON THIS PLAT ARE NAD83 STATE PLANE COORDINATES, UTAH CENTRAL ZONE, U.S. SURVEY FEET.

WILDING ENGINEERING
14721 SOUTH HERITAGE CREEK WAY
BLUFFDALE, UTAH 84065
801.553.8112
WWW.WILDINGENGINEERING.COM

NOT FOR RECORDATION

- SANDY CITY WATER NOTES:
1. NOTIFY SANDY CITY PUBLIC UTILITIES INSPECTOR (801-568-7280), AT LEAST ONE BUSINESS DAY (24 HOURS) PRIOR TO BEGINNING CONSTRUCTION.
 2. A PRE-CONSTRUCTION MEETING IS REQUIRED ONCE FINAL APPROVAL HAS BEEN GRANTED. THE PRE-CONSTRUCTION MEETING SHALL BE SCHEDULED THROUGH SANDY CITY PUBLIC WORKS DEPARTMENT.
 3. ALL CONSTRUCTION SHALL CONFORM TO THE LATEST REVISION OF THE SANDY CITY STANDARD SPECIFICATIONS AND DETAILS FOR MUNICIPAL CONSTRUCTION AND/OR OTHER REQUIREMENTS AS SET FORTH IN THE PUBLIC UTILITIES FINAL REVIEW AND APPROVAL LETTER ESTABLISHED FOR THE DEVELOPMENT. SPECIFICATIONS AND DETAILS CAN BE OBTAINED ON THE SANDY CITY WEBSITE.
 4. SUBMITTALS ARE REQUIRED TO BE APPROVED BY THE ENGINEER FOR ALL BEDDING, BACKFILL, PIPE, METERS, BOXES, VAULTS, VALVES, FIRE HYDRANTS, BLOWOFFS, VAULTS, ETC. RELATING TO THE WATER SYSTEM. SUBMITTALS MUST HAVE SUFFICIENT INFORMATION TO SHOW THAT THE PROPOSED ITEMS CONFORM TO SANDY CITY STANDARDS AND SPECIFICATIONS.
 5. CONSTRUCTION WORK SHALL BE CONDUCTED IN ACCORDANCE WITH THE UTAH POLLUTION DISCHARGE ELIMINATION SYSTEM (UPDES) REGULATIONS.
 6. WATER LINES SHALL BE INSTALLED 4- FEET OFF LIP OF GUTTER ON THE NORTH AND/OR EAST SIDE OF ROADWAY. WATER LINES SHALL NOT BE INSTALLED WITHIN OR THROUGH PARKING STALLS OR UNDER CONCRETE PAVEMENT, UNLESS WATER LINE IS TO BE MAINTAINED BY PRIVATE PROPERTY OWNER.
 7. A MINIMUM OF 48-INCHES AND A MAXIMUM 60-INCHES OF COVER FROM THE TOP OF THE PIPE TO THE FINISH GRADE IS REQUIRED.
 8. FOR CONSTRUCTION EAST OF THE UTAH TRANSIT AUTHORITY'S TRAX LINE, USE DUCTILE IRON PIPE, USE THICKNESS CLASS 52 OR BETTER.
 9. FOR CONSTRUCTION WEST OF UTAH TRANSIT AUTHORITY'S TRAX LINE, USE POLYVINYL CHLORIDE (PVC) PIPE, USE CLASS DR-14 OR BETTER. 10 GAUGE WIRE SHALL BE PLACED ON TOP OF THE PIPE (PER SANDY CITY SPECIFICATIONS) FOR FUTURE RELOCATION. NO DEFLECTION IN PIPE JOINTS WILL BE ALLOWED ON PVC PIPES.
 10. ALL MECHANICAL JOINTS MUST BE RESTRAINED USING MEGA LUGS FOR DIP AND ROMAC GRIP RINGS FOR PVC OR APPROVED EQUAL. MEGA LUGS SHALL NOT BE ALLOWED ON PVC PIPE.
 11. USE 6-INCH COMPRESSION TYPE HYDRANT BY MUELLER CENTURION OR CLOW MEDALLION. EXISTING HYDRANTS REQUIRED FOR FIRE PROTECTION THAT DO NOT MEET CURRENT STANDARDS SHALL BE UPGRADED TO MEET CURRENT SANDY CITY STANDARDS AND SPECIFICATIONS.
 12. WHEN THE DISTANCE FROM THE WATER MAIN TO THE FIRE HYDRANT IS GREATER THAN 6- FEET, AN ADDITIONAL AUXILIARY VALVE SHALL BE FLANGED TO THE FIRE HYDRANT.
 13. ALL DEAD ENDS SHALL BE PLUGGED WITH A 2-INCH WASHOUT OR END WITH A FIRE HYDRANT.
 14. ALL DUCTILE IRON WATER LINES, FITTINGS, AND VALVES SHALL BE POLY-BAGGED IN ACCORDANCE WITH SANDY CITY STANDARDS AND SPECIFICATIONS.
 15. ALL WATER LINES SHALL BE BEDDED WITH SAND (6-INCHES MINIMUM BELOW AND 12-INCHES MINIMUM ON EACH SIDE AND ON TOP OF THE PIPE).

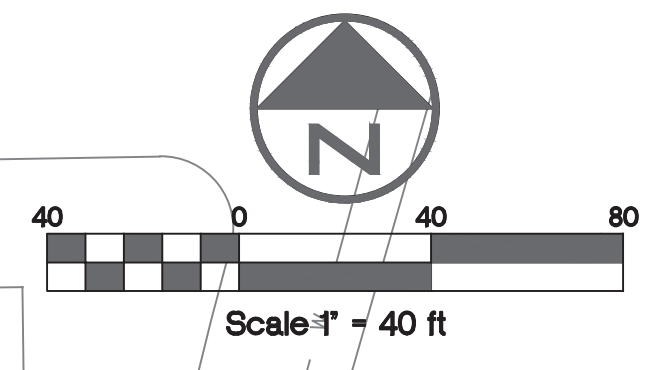

WILDING
ENGINEERING

14721 SOUTH HERITAGE CREST WAY
BLUFFDALE, UTAH 84065
801.553.8112
WWW.WILDINGENGINEERING.COM

DRAWING NOTES:



LEGEND

— W —	PROPOSED WATERLINE
— W —	PROPOSED WATERLINE
⊗	1" WATER SERVICE
■	PROPOSED FIRE HYDRANT
—	PROPOSED GRAVITY SEWER
—	PROPOSED PRESSURE SEWER
⊙	SEWER LATERAL
⊙	STREETLIGHT

NO.	REVISION	DATE

PROJECT INFORMATION

THE ORCHARDS AT DIMPLE DELL

MASTER UTILITY PLAN

SANDY, UTAH

DRAWN BDA	CHECKED MEC	PROJECT # 23232
DATE 2/20/24		SCALE 1" = 40'
SHEET C202		ENGINEER'S STAMP

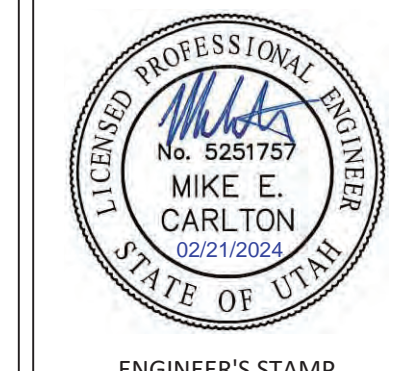

G:\DATA\23232 Brett Lovell - Dimple Dell.dwg\3232.dimple Dell C101 Overall Sheets.dwg
PLOT DATE: Feb 21, 2024

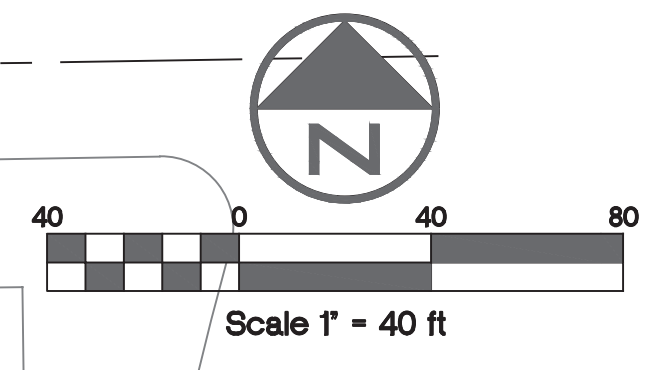

WILDING
ENGINEERING

14721 SOUTH HERITAGE CREST WAY
BLUFFDALE, UTAH 84065
801.553.8112
WWW.WILDINGENGINEERING.COM

- DRAWING NOTES:**
- SANDY STORM WATER NOTES:
1. NOTIFY SANDY CITY PUBLIC UTILITIES INSPECTOR (801-568-7280), AT LEAST ONE BUSINESS DAY (24 HOURS) PRIOR TO BEGINNING CONSTRUCTION.
 2. A PRE-CONSTRUCTION MEETING IS REQUIRED ONCE FINAL APPROVAL HAS BEEN GRANTED. THE PRE-CONSTRUCTION MEETING SHALL BE SCHEDULED THROUGH SANDY CITY PUBLIC WORKS DEPARTMENT.
 3. ALL CONSTRUCTION SHALL CONFORM TO THE LATEST REVISION OF THE SANDY CITY STANDARD SPECIFICATIONS AND DETAILS FOR MUNICIPAL CONSTRUCTION AND/OR OTHER REQUIREMENTS AS SET FORTH IN THE PUBLIC UTILITIES FINAL REVIEW AND APPROVAL LETTER ESTABLISHED FOR THE DEVELOPMENT. SPECIFICATIONS AND DETAILS CAN BE OBTAINED ON THE SANDY CITY WEBSITE.
 4. SUBMITTALS ARE REQUIRED TO BE APPROVED BY THE ENGINEER FOR ALL BEDDING, BACKFILL, PIPE, AND STRUCTURES (INLET BOXES, COMBO BOXES, AND JUNCTION BOXES). SUBMITTALS MUST HAVE SUFFICIENT INFORMATION TO SHOW THAT THE PROPOSED ITEMS CONFORM TO SANDY CITY STANDARDS AND SPECIFICATIONS.
 5. CONSTRUCTION WORK SHALL BE CONDUCTED IN ACCORDANCE WITH THE UTAH POLLUTION DISCHARGE ELIMINATION SYSTEM (UPDES) REGULATIONS.
 6. ALL MATERIALS AND WORK DONE IN UDOT RIGHT-OF-WAY SHALL CONFORM TO UDOT STANDARDS AND SPECIFICATIONS (DELETE IF NOT APPLICABLE).
 7. NON-SHRINK GROUT SHALL BE USED WHEREVER GROUT IS REQUIRED FOR THE STORM DRAIN FACILITIES.
 8. CUT PIPES OFF FLUSH WITH THE INSIDE WALL OF THE BOX OR MANHOLE AND GROUT AT CONNECTION OF PIPE TO BOX TO A SMOOTH FINISH. ADDITIONALLY, ALL JAGGED OR SHARP EDGES AT PIPE CONNECTIONS ARE TO BE REMOVED AND GROUDED SMOOTH.
 9. GROUT BETWEEN GRADE RINGS. FOR EACH INLET BOX THAT IS LOCATED NEXT TO A CURB, THE CURB AND GUTTER CONTRACTOR IS RESPONSIBLE TO REMOVE ALL PROTRUDING, JAGGED OR SHARP CONCRETE EDGES AND TO GROUT BETWEEN BOTTOM OF INLET LID FRAME AND TOP OF CONCRETE BOX. GROUT TO CREATE A SMOOTH, BEVELLED TRANSITION AT ALL EDGES IN CLEAN OUT AND INLET BOXES. GROUT AROUND ALL EDGES OF THE RESTRICTIVE ORIFICE PLATE.
 10. REMOVE SNAP TIES, NAILS, REBAR AND OTHER PROTRUSIONS FROM THE BOX OR PIPE INSIDE SURFACE, AS WELL AS ALL FORM WORK, PLASTIC AND CARDBOARD.
 11. SILT AND DEBRIS ARE TO BE CLEANED OUT OF ALL INLET BOXES, COMBO BOXES, JUNCTION BOXES, AND PIPE. THE BOXES AND PIPES ARE TO BE MAINTAINED IN A CLEAN CONDITION UNTIL AFTER THE FINAL BOND RELEASE INSPECTION.
 12. CLEAN OFF ALL MANHOLE LIDS AND INLET GRATES OF ASPHALT, CONCRETE, TAR OR OTHER ADHESIVES TO ALLOW ACCESS.
 13. WHERE A SUMP IS REQUIRED, THE SANDY CITY PUBLIC UTILITIES INSPECTOR SHALL BE CONTACTED PRIOR TO CONSTRUCTION TO PROVIDE AN OPPORTUNITY TO CHECK THE VOLUME OF GRAVEL AND GRAVEL GRADATION.
 14. SIGNS MUST BE POSTED NEAR EACH INLET BOX LOCATED IN A DRINKING WATER RECHARGE ZONE, WITH THE FOLLOWING WORDS: "WARNING THIS IS A DRINKING WATER AQUIFER RECHARGE AREA. DISPOSAL OF ANY WASTE MATERIALS IN THE STORM WATER IS STRICTLY PROHIBITED."
 15. ALL INLET, COMBO AND JUNCTION BOXES SHALL BE PLACED ON 12-INCH (MIN.) COMPACTED STABILIZATION MATERIAL.
 16. A VIDEO OF ALL PIPES MUST BE COMPLETED BEFORE THE 80% OR 90% BOND RELEASE AND AGAIN BEFORE FINAL BOND RELEASE.
 17. A REPRESENTATIVE OF THE MANUFACTURER OR SUPPLIER SHALL BE ON SITE DURING INSTALLATION OF OIL/WATER SEPARATOR, MECHANICAL TREATMENT DEVICES, MEDIA FILTERS, AND UNDERGROUND DETENTION/RETENTION SYSTEMS. THE MANUFACTURER OR SUPPLIER SHALL PROVIDE A LETTER STATING THAT THE SYSTEM WAS INSTALLED PER MANUFACTURER'S SPECIFICATIONS. IF IT IS UNKNOWN WHETHER A REPRESENTATIVE IS REQUIRED TO BE PRESENT DURING INSTALLATION, CONTACT THE SANDY CITY PUBLIC UTILITIES INSPECTOR.
 18. A STAMPED "LETTER OF CONFORMANCE" FROM THE DESIGN ENGINEER IS REQUIRED TO BE SUBMITTED TO SANDY CITY PUBLIC UTILITIES DEPARTMENT, PRIOR TO 90% BOND RELEASE, STATING THAT STORM WATER FLOW CONTROL ELEMENTS AND STORM WATER TREATMENT FACILITIES (E.G. DETENTION, RETENTION, LID BEST MANAGEMENT PRACTICES, OIL-WATER SEPARATORS, SUMPS, ETC.) WERE CONSTRUCTED ACCORDING TO THE APPROVED PLANS.

LEGEND

	EXISTING CONTOUR (5')
	EXISTING CONTOUR (1')
	PROPOSED CONTOUR (5')
	PROPOSED CONTOUR (1')

NO.	REVISION	DATE

PROJECT INFORMATION

THE ORCHARDS AT DIMPLE DELL

MASTER GRADING AND DRAINAGE PLAN

SANDY, UTAH

DRAWN BDA	CHECKED MEC	PROJECT # 23232
		DATE 2/20/24
		SCALE 1" = 40'
		SHEET C203

RETENTION BASIN
TOTAL VOLUME REQUIRED=15,751 CU FT
DESIGN INFILTRATION RATE=5 MIN/IN

VOLUME PROVIDED
ABOVE GROUND=8,783 CU FT
UNDER GROUND=7,063 CU FT
VOLUME AS SHOWN=15,846 CU FT

BASIN CHARACTERISTICS
BASIN TOP=4940
HIGHWATER=4939
BOTTOM=4936
DEPTH= 3.0'
3:1 SIDE SLOPES

STORMTECH CHAMBERS
22 MC-7200 CHAMBERS
TOP OF CHAMBERS=4934
BOTTOM OF CHAMBERS=4929
BOTTOM OF GRAVEL=4928.25

G:\DATA\23232 Brett Lovell - Dimple Dell.dwg 23232 Dimple Dell C101 Overall Sheets.dwg PLOT DATE: Feb. 21, 2024