

(A) The District Building  
8000 E. 1st Ave., Suite 100  
Salt Lake City, UT 84143  
(B) 801.555.1000  
(C) [www.eda.com](http://www.eda.com)

PROJECT NUMBER: 2023



**LLOYD**  
ENGINEERS & ARCHITECTS  
1305 S. VAN HANDEL BLVD.  
SUITE 100  
SALT LAKE CITY, UT 84143  
PH: 801.555.1000

WATERFORD SCHOOL  
SPORTS FIELD AND  
PARKING

1400 E. 9400 S.  
SANDY, UT 84085

PROJECT NUMBER	DATE
1. SITE PLAN SUBMITTAL	3/26/2023

GRAPHICS  
PLAN

PF6.0  
2023

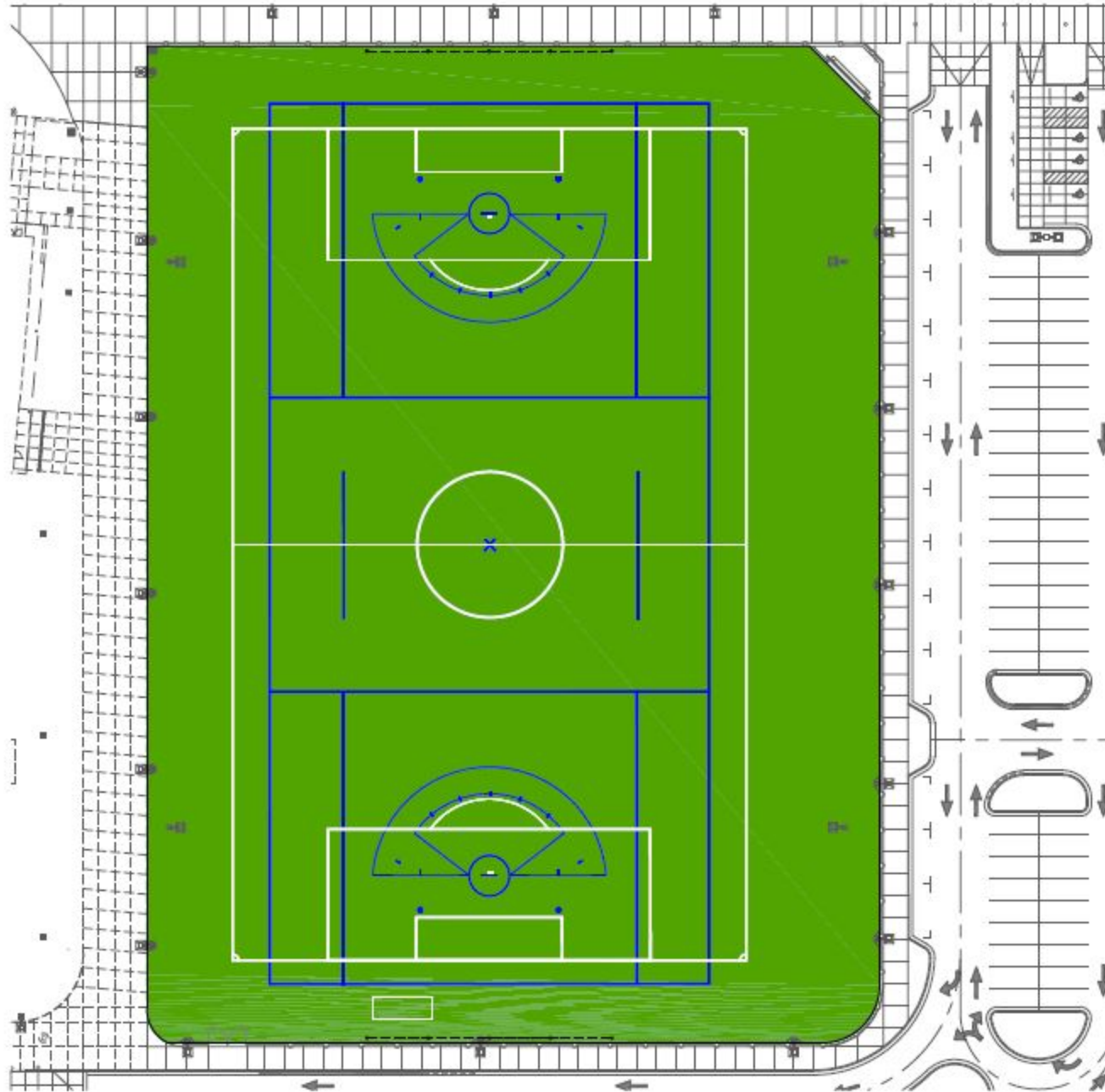

## COLOR LIST:

SOCCER LINE COLOR: WHITE  
(FOR FIFA SOCCER RULES)  
LACROSSE COLOR: BLUE  
(FOR MHS LIMITED LACROSSE RULES)  
FIELD COLOR:  
GREEN

## GRAPHICS GENERAL NOTES:

1. GENERAL CONTRACTOR IS RESPONSIBLE FOR PREPARATION OF THE SHOP DRAWINGS AND FOR COORDINATION WITH THE TURF INSTALLER WORK. TURF INSTALLER MUST SUBMIT COMPLETE SHOP DRAWINGS AND COLOR SAMPLES FOR REVIEW AND APPROVAL PRIOR TO INSTALLATION OF SYNTHETIC TURF. SUBMITTALS FOR SHOP DRAWINGS AND COLOR SAMPLES MUST BE IN ACCORDANCE WITH THE SPECIFICATIONS.
2. THE OWNER (OR ITS REPRESENTATIVE) MUST REVIEW AND APPROVE THE FONTS USED FOR YARD AND ZONE NUMBERING AND ZONE LETTERING PRIOR TO INSTALLATION OF THE SYNTHETIC TURF.
3. CONTRACTOR MAY USE THE STANDARD COLOR PALETTE, HOWEVER, IF THEIR STANDARD COLORS ARE NOT CONSISTENT WITH THIS DRAWING AND STRICT EXPECTATIONS, THEN CUSTOM COLORS SHALL BE PROVIDED. CONTRACTOR MAY SUBMIT COLOR SWATCHES DURING OR WITH THEIR BID FOR REVIEW BY THE SCHOOL DISTRICT.

## LEGEND:

NEW SYNTHETIC TURF PLAYING FIELD





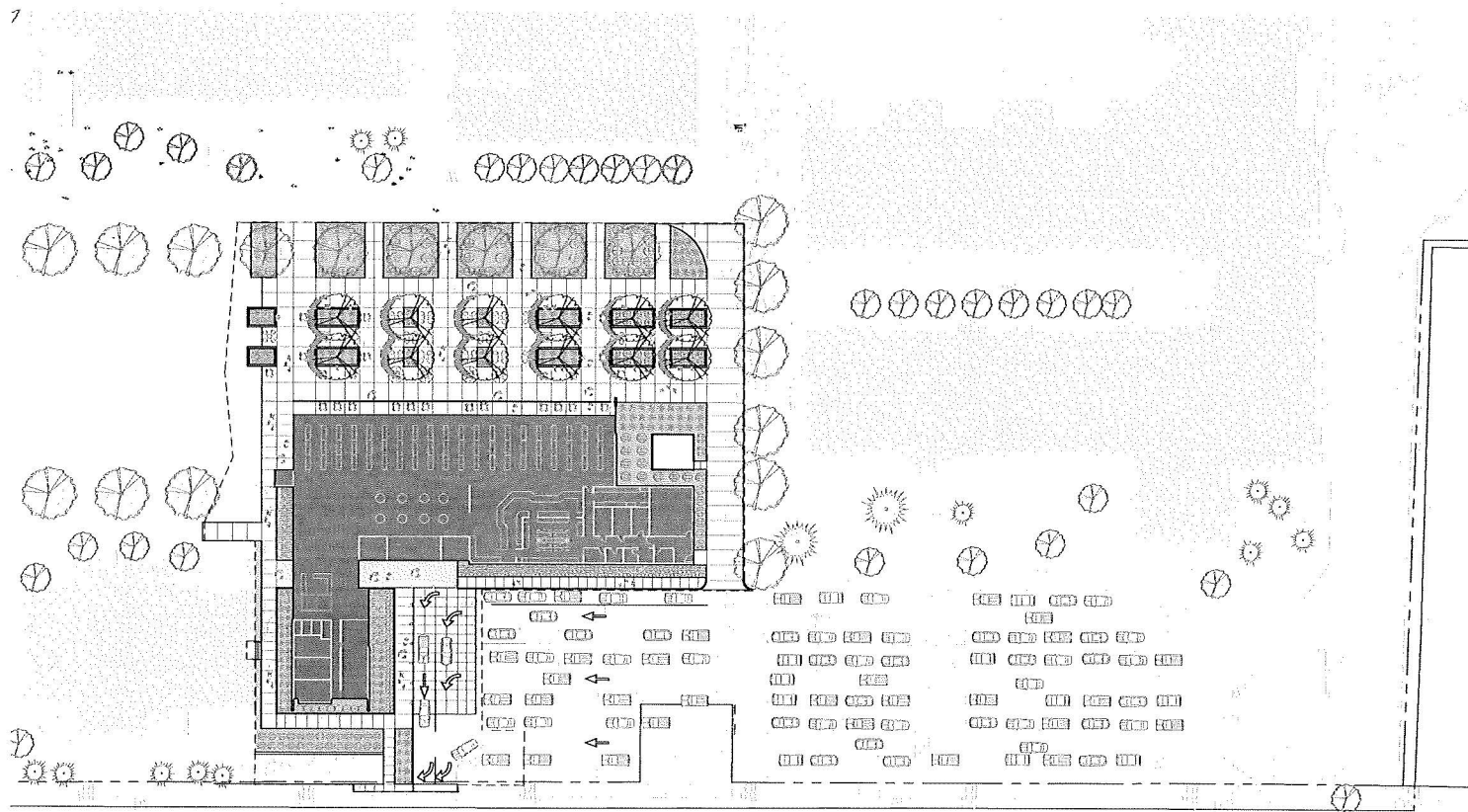



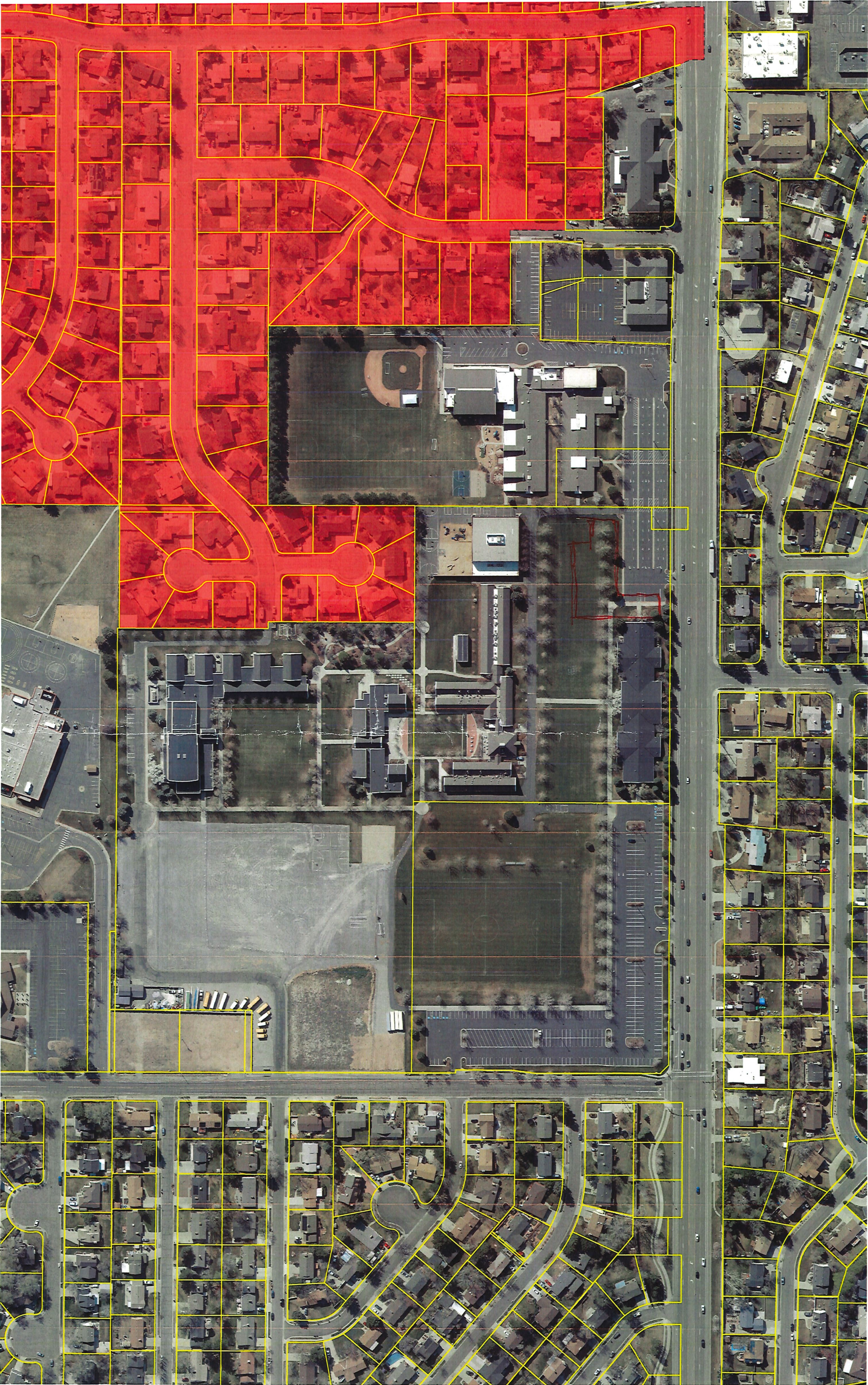



Please show RTUs dashed in behind the parapet on building elevations and colored renderings.

ED  
A

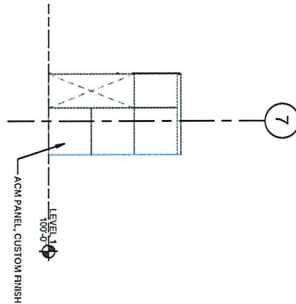
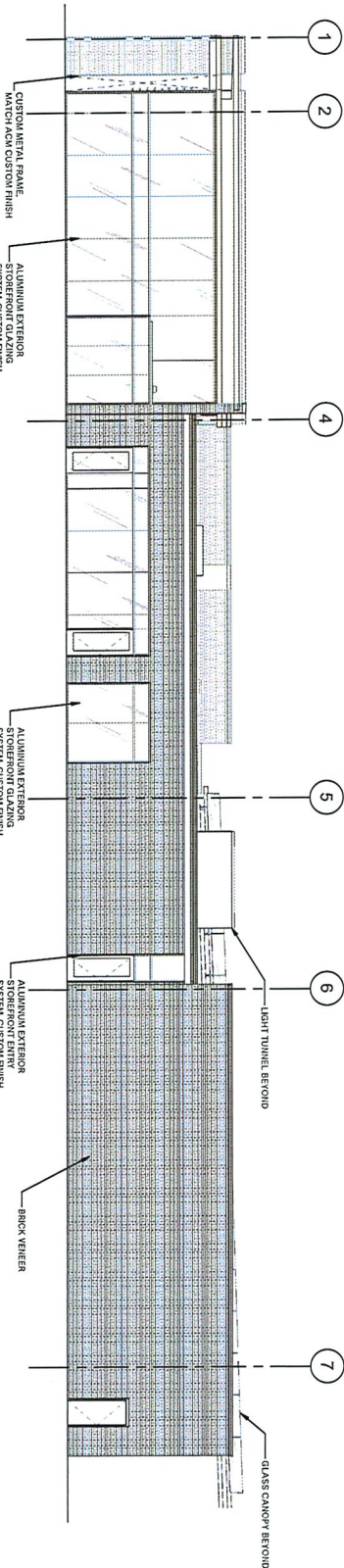

9 EAST OVERALL BUILDING ELEVATION  
1/8" = 1'-0"

8 SOUTH ELEVATION BUMP OUT  
1/8" = 1'-0"

7 EAST ELEVATION - MAIN ENTRANCE  
1/8" = 1'-0"

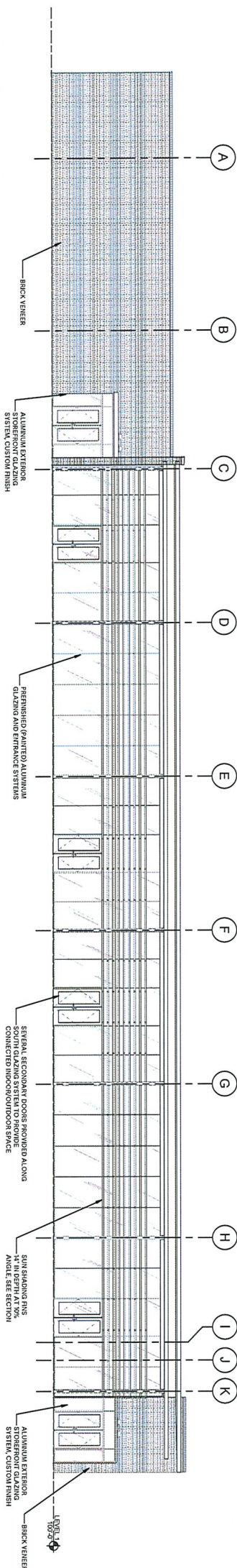

CONSULTANT LOGO

6 SOUTH OVERALL BUILDING ELEVATION  
1/8" = 1'-0"

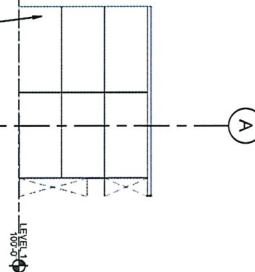
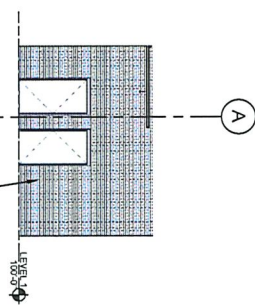
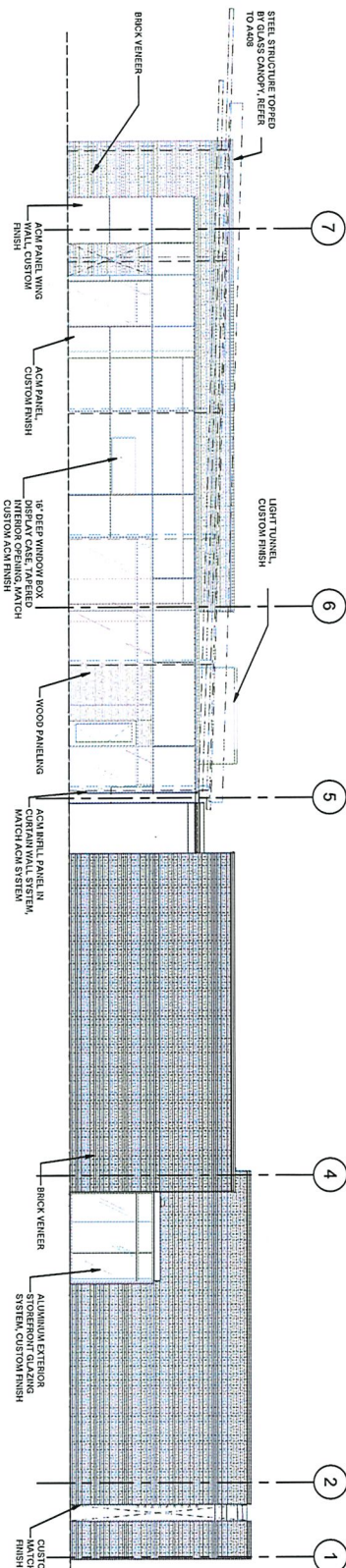

5 WEST OVERALL BUILDING ELEVATION  
1/8" = 1'-0"

4 NORTH ELEVATION DELIVERY AREA  
1/8" = 1'-0"

3 SOUTH ELEVATION DELIVERY AREA  
1/8" = 1'-0"

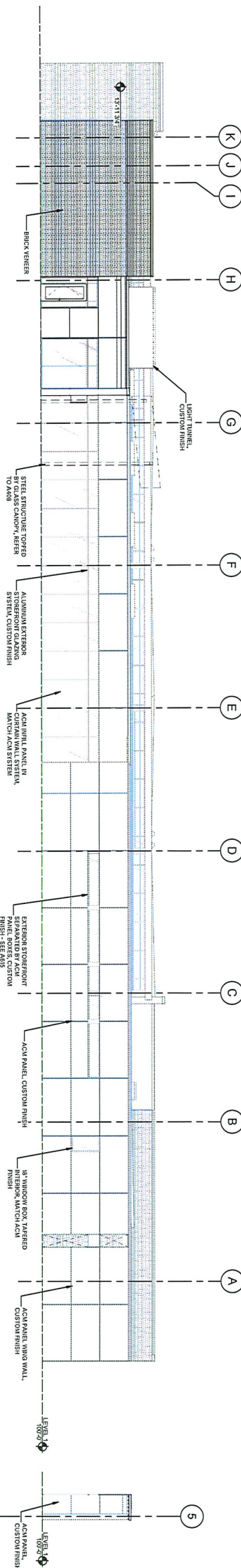

2 NORTH OVERALL BUILDING ELEVATION  
1/8" = 1'-0"

1 NORTH BUMP OUT  
1/8" = 1'-0"

NOT FOR  
CONSTRUCTION

04 The Burtin Building  
9 Exchange Place, Suite 100  
Salt Lake City, Utah 84111  
01 801.531.7000  
02 info@ed3studio.com  
03 info@ed3studio.com  
04 www.ed3studio.com

PROJECT ARCHITECT  
PROJECT MANAGER  
PA  
PM

WATERFORD SCHOOL  
STUDENT COMMONS

1520 EAST 9400 SOUTH  
SANDY, UT 84093

PROJECT NUMBER 210121  
DESCRIPTION NTE  
00 SUBMITTAL 03.10.23

BUILDING  
ELEVATIONS

A200

10 MARCH 2023

© EDA



DIMENSION & SLAB PLAN NOTES		
1. COORDINATE DIMENSIONS SHOWN WITH ALL TRADES AND SYSTEM REQUIREMENTS.	5. DIMENSIONS TO INTERIOR WALL PARTITIONS ARE TO THE FINISH FACE OF THE PARTITION, UNLESS NOTED OTHERWISE. CONTRACTORS SHALL REFER TO THE WALL TYPES AND INTERIOR ELEVATIONS FOR WALL ASSEMBLIES AND MATERIALS AND COORDINATE WALL LAYOUT TO ENSURE FINISH ALIGNMENTS AND CODE REQUIRED CLEARANCE ARE PROVIDED.	8. DOOR OPENINGS SHALL BE LOCATED TO PROVIDE FOR THE ACCESSIBILITY MAINTAINING CLEARANCES IN COMPLIANCE WITH ADA REQUIREMENTS. REFER TO ADA GUIDELINE SHEETS IN THE GENERAL INFORMATION IN THIS SET OF DRAWINGS. CONFIRM ALL OPENINGS IN QUESTION WITH ARCHITECT.
2. DIMENSIONS SHOWN AT FOUNDATION WALLS ARE INTENDED TO LOCATE WHERE FOUNDATION WALL TYPE CHANGES BASED ON THE WALL ASSEMBLY ABOVE, COORDINATE WITH AND REFERENCE ARCHITECTURAL DRAWINGS FOR ADDITIONAL INFORMATION.	6. WHERE DIMENSIONS ARE SHOWN TO LOCATE PENETRATIONS AT FLOOR SLABS, CENTERLINES OF WALL FOR PLUMBING, MAY BE PROVIDED. COORDINATION WITH SURROUNDING WALL LAYOUTS AND LOCATIONS TO ENSURE CLEAR OR FINISHED DIMENSIONS ARE PROVIDED. CODE OR MATERIAL ALIGNMENTS MAY OCCUR.	9. PROVIDE 1/2" GAP AT PERIMETER OF THE FLOOR SLAB AT EXTERIOR WALLS. PROVIDE INSULATION AND CONTINUOUS SEALANT.
3. THE INTERIOR FACE OF ALL FOUNDATION WALLS AROUND THE BUILDING ARE INTENDED TO BE IN THE SAME PLANE. REFER TO THE TYPICAL FOUNDATION DETAILS IN THE ARCHITECTURAL DRAWINGS FOR THE DIMENSION FROM GRID AND THE RELATIONSHIP OF THE STUD WALL OR GLAZING SYSTEM.	7. OPENINGS OR ELEMENTS IN FLOOR SLABS: CONTRACTOR SHALL COORDINATE OPENING SIZE, AND LOCATION, REQUIREMENTS WITH ACTUAL EQUIPMENT BEING SUPPLIED.	10. COORDINATE ACTUAL SIZE AND DEPTH OF THE ELEVATOR FOUNDATION WITH THE ELEVATOR BEING SUPPLIED.
4. AT EXTERIOR WALLS, THE INTERIOR FACE OF THE STUD FRAMING IS INTENDED TO ALIGN WITH THE INTERIOR FACE OF THE CONCRETE FOUNDATION WALLS, TYPICAL.		11. REFER TO ENLARGED PLANS FOR ADDITIONAL DIMENSIONING.

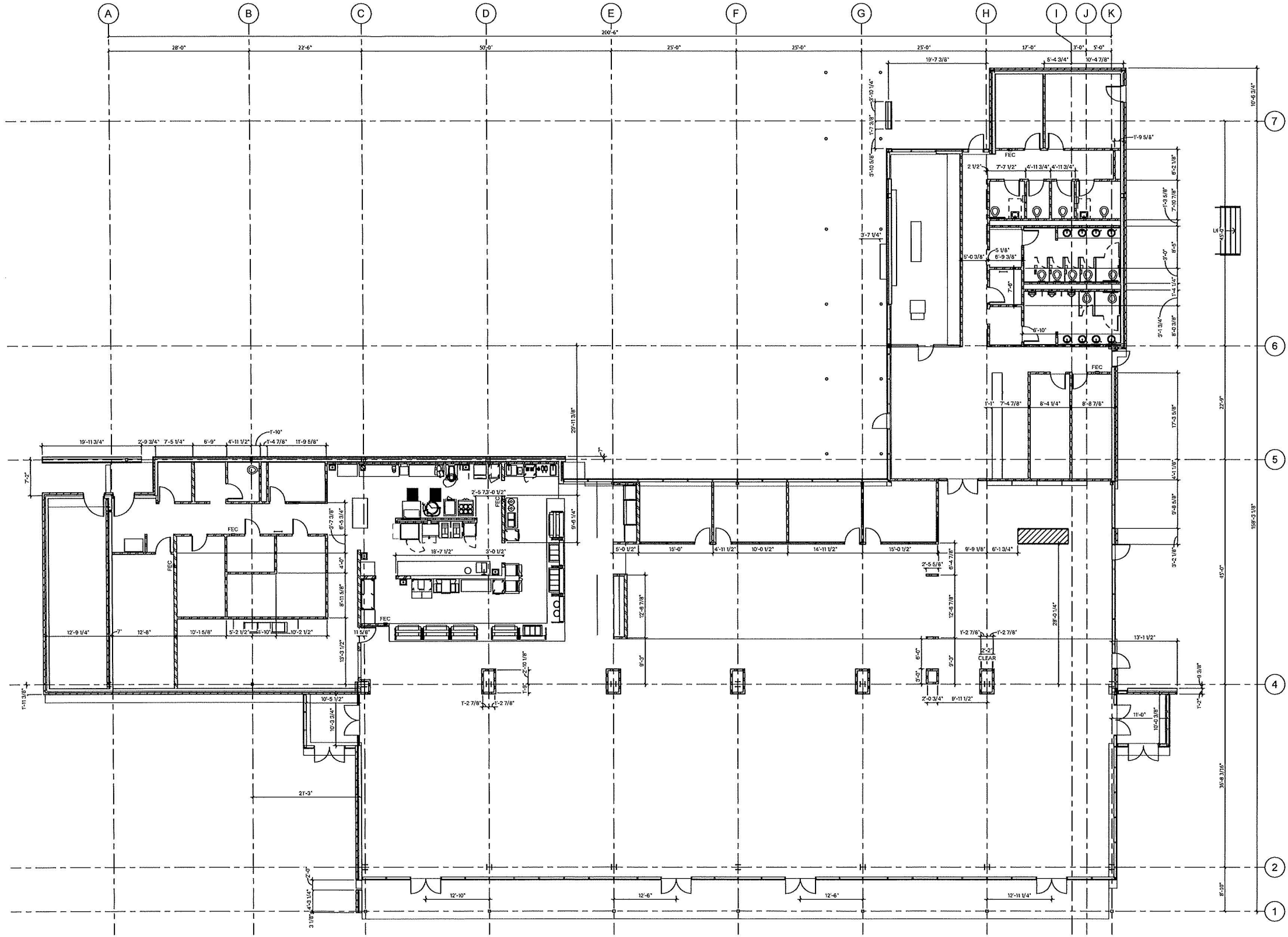

[A] The Boston Building  
9 Exchange Place, Suite 1100  
Salt Lake City, Utah 84111

[O] 801 531 7600

[E] info@edsarch.com

[W] www.edsarch.com

PROJECT ARCHITECT PA  
PROJECT MANAGER PR

NOT FOR  
CONSTRUCTION

CONSULTANT LOGO

WATERFORD SCHOOL  
STUDENT COMMONS

1520 EAST 9400 SOUTH  
SANDY, UT 84093

PROJECT NUMBER 219121  
DESCRIPTION DATE  
00 SUBMITTAL 02.10.23

LEVEL 1  
DIMENSIONED PLAN

A101  
10 MARCH 2023





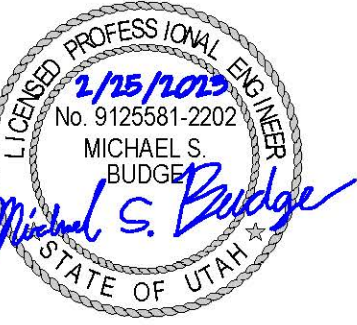
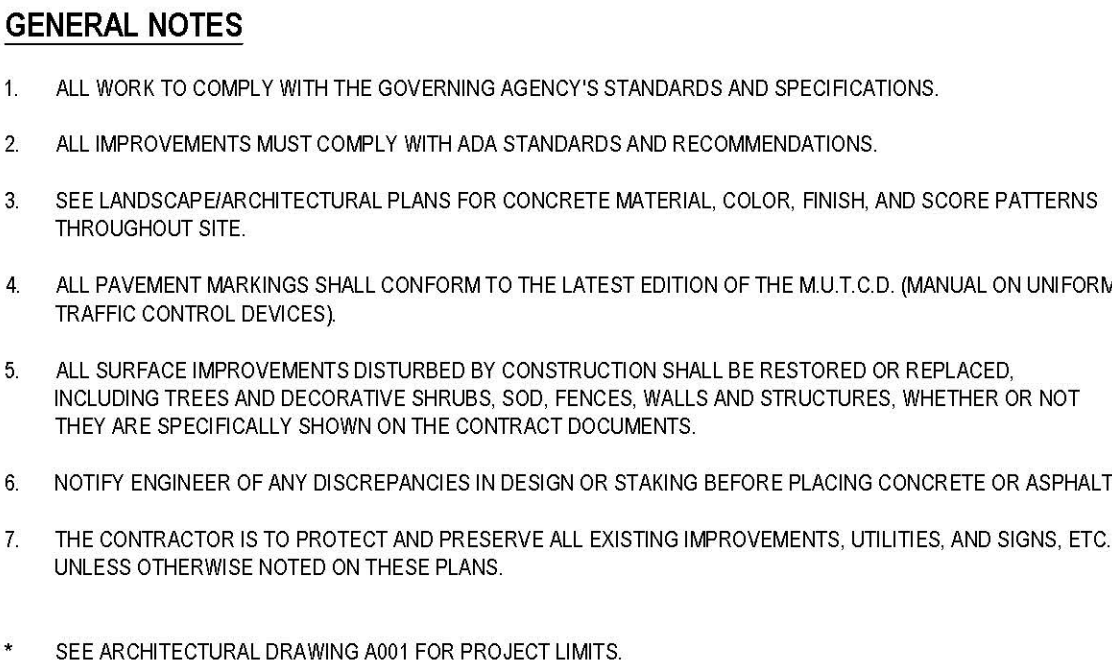

**SALT LAKE CITY**  
45 W. 10000 S., Suite 500  
Sandy, UT 84070  
Phone: 801.255.0529

**WWW.ENSIGNENG.COM**  
**ENSIGN PROJECT #10651B**

# WATERFORD SCHOOL PARKING ADDITION

1480 E 9400 S  
SANDY, UT 84093

WATERFORD EAST PARKING LOT DATA TABLE	
TOTAL EXISTING STALLS	314
EXIST. ADA STALLS	8
EXIST. ADA STALLS TO BE REMOVED	5
TOTAL STALLS TO BE REMOVED	74
PROPOSED STANDARD STALLS	284
PROPOSED ADA STALLS	12
TOTAL STALLS	536 (INC. 15 ADA)

PROJECT NUMBER		-
#	DESCRIPTION	DATE
1	SITE PLAN SUBMITTAL	2/28/2023

## OVERALL SITE PLAN

# C-200



811

CALL BLUESTAKES  
@ 811 AT LEAST 48  
HOURS PRIOR TO THE  
COMMENCEMENT OF  
ANY CONSTRUCTION.  
Know what's below.  
Call before you dig.

BENCHMARK

NORTH QUARTER CORNER OF  
SECTION 9, TOWNSHIP 3 SOUTH,  
RANGE 1 EAST  
SALT LAKE BASE AND MERIDIAN  
BM ELEVATION = 4790.40

GENERAL NOTES

- ALL WORK TO COMPLY WITH THE GOVERNING AGENCY'S STANDARDS AND SPECIFICATIONS.
- ALL IMPROVEMENTS MUST COMPLY WITH ADA STANDARDS AND RECOMMENDATIONS.
- SEE LANDSCAPE/ARCHITECTURAL PLANS FOR CONCRETE MATERIAL, COLOR, FINISH, AND SCORE PATTERNS THROUGHOUT SITE.
- ALL PAVEMENT MARKINGS SHALL CONFORM TO THE LATEST EDITION OF THE M.U.T.C.D. (MANUAL ON UNIFORM TRAFFIC CONTROL DEVICES).
- ALL SURFACE IMPROVEMENTS DISTURBED BY CONSTRUCTION SHALL BE RESTORED OR REPLACED, INCLUDING TREES AND DECORATIVE SHRUBS, SOD, FENCES, WALLS AND STRUCTURES, WHETHER OR NOT THEY ARE SPECIFICALLY SHOWN ON THE CONTRACT DOCUMENTS.
- NOTIFY ENGINEER OF ANY DISCREPANCIES IN DESIGN OR STAKING BEFORE PLACING CONCRETE OR ASPHALT.
- THE CONTRACTOR IS TO PROTECT AND PRESERVE ALL EXISTING IMPROVEMENTS, UTILITIES, AND SIGNS, ETC. UNLESS OTHERWISE NOTED ON THESE PLANS.

SEE ARCHITECTURAL DRAWING A001 FOR PROJECT LIMITS.

SCOPE OF WORK:

PROVIDE, INSTALL AND/OR CONSTRUCT THE FOLLOWING PER THE SPECIFICATIONS GIVEN OR REFERENCED, THE DETAILS NOTED, AND/OR AS SHOWN ON THE CONSTRUCTION DRAWINGS:

- CONCRETE SIDEWALK PER APWA PLAN 231 AND SPECIFICATIONS. SAWCUT JOINTS AND COLOR PER LANDSCAPE PLANS.
- CONCRETE PAVEMENT PER DETAIL 11C-600. JOINTS TO BE INSTALLED PER APWA PLAN 261 3/C-601 AND SPECIFICATIONS. CONSTRUCTION JOINT SPACING NOT TO EXCEED 100'.
- ASPHALT PAVEMENT PER DETAIL 7/C-600.
- TRANSITION BETWEEN COLLECTION CURB AND GUTTER AND REVERSE PAN CURB AND GUTTER.
- 24" COLLECTION CURB AND GUTTER PER DETAIL 9/C-600.
- 24" REVERSE PAN CURB AND GUTTER PER DETAIL 10/C-600.
- 4" WIDE SOLID WHITE PAVEMENT MARKING PER M.U.T.C.D. STANDARD PLANS.
- "HANDICAP PARKING" SIGN PER M.U.T.C.D. STANDARD PLANS.
- PAINTED ADA SYMBOL AND ASSOCIATED HATCHING PER M.U.T.C.D. STANDARD PLANS.
- SITE LIGHTING SHOWN FOR REFERENCE. SEE PHOTOMETRIC PLANS FOR DESIGN AND FINAL LAYOUT.
- SEE SHEET C-204 FOR FIRE ROUTE.
- "END OF FIRE APPARATUS ACCESS ROAD" SIGN PER DETAIL 8/C-600.
- 4 FOOT HIGH ORNAMENTAL FENCE PER LANDSCAPE PLANS.

- INSTALL FENCE GATE.
- ASPHALT PAVEMENT EDGE.
- 8" CONCRETE WATERWAY PER SANDY CITY STANDARD DRAWING CG-03.
- 6" TYPE "P" CURB WALL PER APWA STANDARD PLAN 209.
- HANDICAP ACCESS RAMP PER APWA STANDARD PLAN 235 WITH DETECTABLE WARNING SURFACE PER APWA STANDARD PLAN 238.
- REMOVABLE BOLLARD.
- TYPE "A" CURB AND GUTTER WITH 0" CURB FACE SIMILAR TO APWA STANDARD PLAN 205.
- SANDY CITY RESIDENTIAL STREET LIGHT SHOWN FOR REFERENCE. SEE PHOTOMETRIC PLANS FOR DESIGN AND FINAL LAYOUT.
- PAINTED LANE-USE ARROWS PER M.U.T.C.D. STANDARD PLANS.
- TRASH ENCLOSURE PER ARCHITECTURAL PLANS WITH 6" THICK CONCRETE APRON WITH #4 REBAR @ 24" O.C. E.W. ON 6" GRAVEL BASE.
- 18" CONCRETE MOW CURB.
- 4" WATERWAY PER APWA STANDARD PLAN NO. 211.
- 20'x60" SIGHT TRIANGLE.

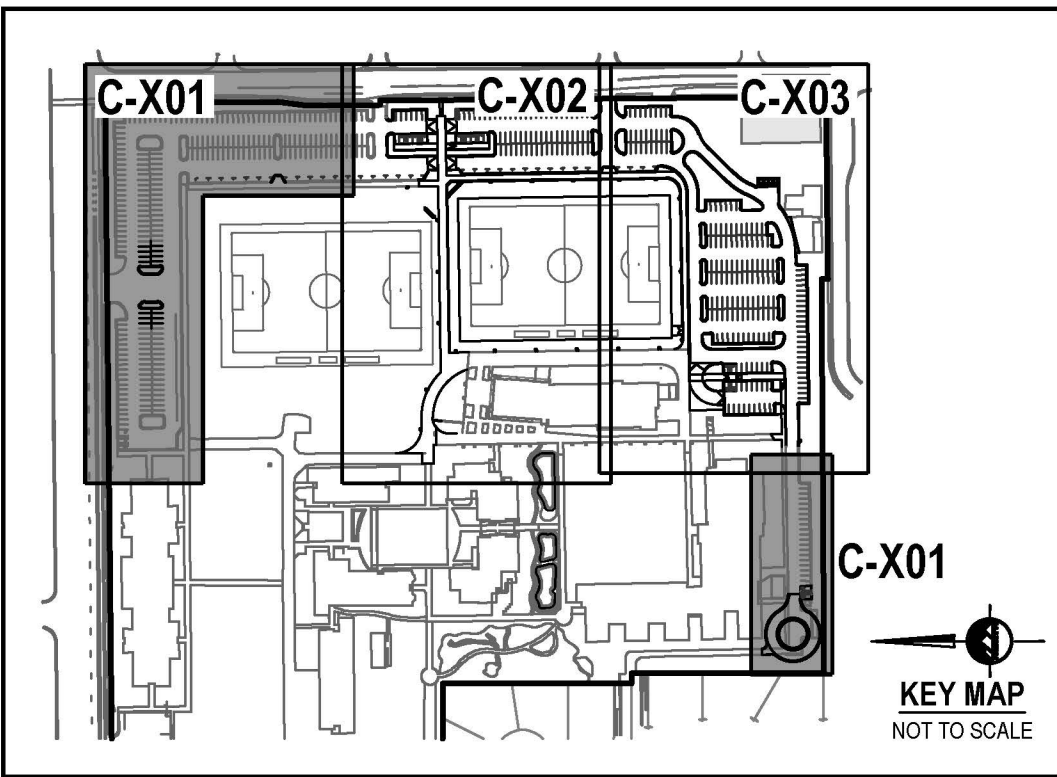
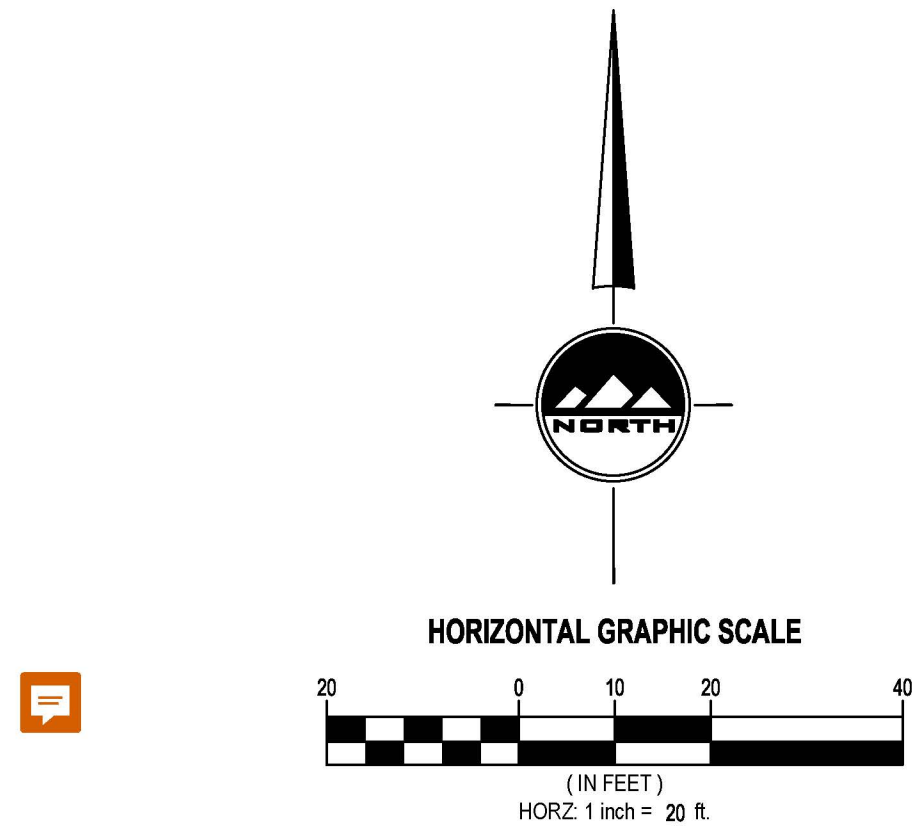

[A] The Boston Building  
9 Exchange Place, Suite 1100  
Salt Lake City, Utah 84111

[C] 801 531 7600

[E] info@edaarch.com

[W] www.edaarch.com

PROJECT ARCHITECT JH  
PROJECT MANAGER KL

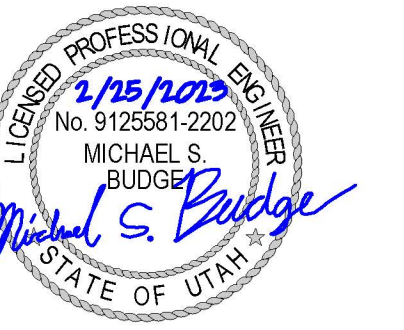

**SALT LAKE CITY**  
45 W. 10000 S., Suite 500  
Sandy, UT 84070  
Phone: 801.255.0529

[www.ensigneng.com](http://www.ensigneng.com)  
ENSIGN PROJECT #10651B

**WATERFORD SCHOOL  
PARKING ADDITION**

1480 E 9400 S  
SANDY, UT 84093

PROJECT NUMBER		
#	DESCRIPTION	DATE
1	SITE PLAN SUBMITTAL	2/28/2023

SITE PLAN

**C-201**  
2023

C/EDA

2/27/2023 12:22:25 PM

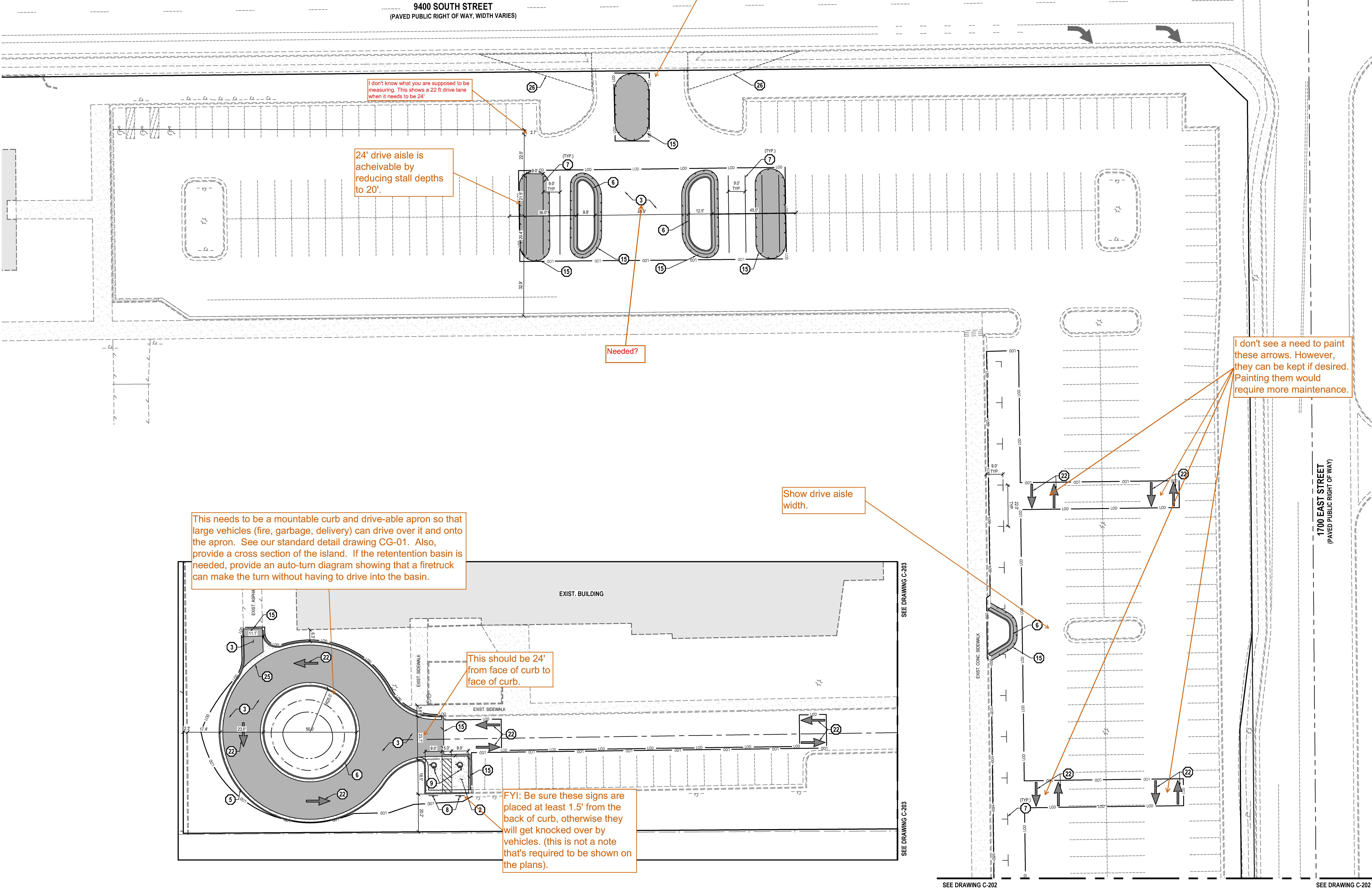



811

CALL BLUESTAKES  
@ 811 AT LEAST 48  
HOURS PRIOR TO THE  
COMMENCEMENT OF  
ANY CONSTRUCTION.  
Know what's below.  
Call before you dig.

BENCHMARK

NORTH QUARTER CORNER OF  
SECTION 9, TOWNSHIP 3 SOUTH,  
RANGE 1 EAST  
SALT LAKE BASE AND MERIDIAN  
BM ELEVATION = 4790.40

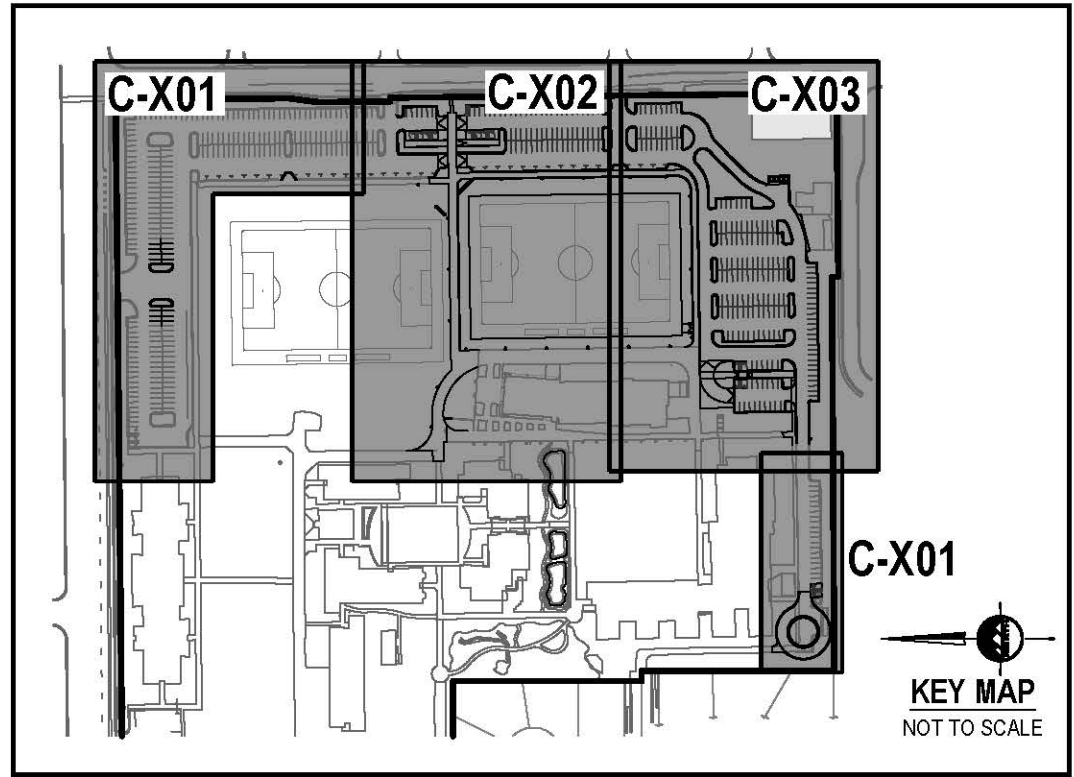

SANDY CITY STORM WATER NOTES

- NOTIFY SANDY CITY PUBLIC UTILITIES INSPECTOR, 801-568-7280, AT LEAST ONE WORKING DAY (24 HOURS) PRIOR TO BEGINNING ANY CONSTRUCTION.
- A PRE-CONSTRUCTION MEETING IS REQUIRED ONCE FINAL APPROVAL HAS BEEN GRANTED. THE PRE-CONSTRUCTION MEETING SHALL BE SCHEDULED THROUGH SANDY CITY CITY PUBLIC WORKS DEPARTMENT.
- ALL CONSTRUCTION SHALL CONFORM TO THE LATEST REVISION OF THE SANDY CITY STANDARD SPECIFICATIONS AND DETAILS FOR MINORAL CONSTRUCTION AND/OR OTHER REQUIREMENTS AS SET FORTH IN THE PUBLIC UTILITIES FINAL REVIEW AND APPROVAL LETTER ESTABLISHED FOR THE DEVELOPMENT. SPECIFICATIONS AND DETAILS CAN BE OBTAINED ON THE SANDY CITY WEBSITE.
- SUBMITTALS ARE REQUIRED TO BE APPROVED BY THE ENGINEER FOR ALL BEDDING, BACKFILL, PIPE, AND STRUCTURES (INLET BOXES, COMBO BOXES, AND JUNCTION BOXES). SUBMITTALS MUST HAVE SUFFICIENT INFORMATION TO SHOW THAT THE PROPOSED ITEMS CONFORM TO SANDY CITY STANDARDS AND SPECIFICATIONS.
- CONSTRUCTION WORK SHALL BE CONDUCTED IN ACCORDANCE WITH THE UTAH POLLUTION DISCHARGE ELIMINATION SYSTEM (LPDES) REGULATIONS.
- NON-SHRINK GROUT SHALL BE USED WHEREVER GROUT IS REQUIRED FOR THE STORM DRAIN FACILITIES.
- OUT PIPES OFF FLUSH WITH THE INSIDE WALL OF THE BOX OR MANHOLE AND GROUT AT CONNECTION OF PIPE TO BOX AS A SMOOTH FINISH. ADDITIONALLY, ALL JAGGED OR SHARP EDGES AT PIPE CONNECTIONS ARE TO BE REMOVED AND GROUTED SMOOTH.
- GROUT BETWEEN GRADE RINGS, FOR EACH INLET BOX THAT IS LOCATED NEXT TO A CURB, THE CURB AND GUTTER CONTRACTOR IS RESPONSIBLE TO REMOVE ALL PROTRUDING, JAGGED OR SHARP CONCRETE EDGES AND TO GROUT BETWEEN BOTTOM OF INLET LID FRAME AND TOP OF CONCRETE BOX. GROUT TO CREATE A SMOOTH, BEVELED TRANSITION AT ALL EDGES IN CLEAN OUT AND INLET BOXES. GROUT AROUND ALL EDGES OF THE RESTRICTIVE ORNICE PLATE.
- REMOVE SNAP TIES, NAILS, REBAR AND OTHER PROTRUSIONS FROM THE BOX OR PIPE INSIDE SURFACE, AS WELL AS ALL FOR WORK, PLASTIC AND CARDBOARD.
- SILT AND DEBRIS ARE TO BE CLEANED OUT OF ALL INLET BOXES, COMBO BOXES, JUNCTION BOXES, AND PIPE. THE BOXES AND PIPES ARE TO BE MAINTAINED IN A CLEAN CONDITION UNTIL AFTER THE FINAL BOND RELEASE INSPECTION.
- CLEAN OFF ALL MANHOLE LIDS AND INLET GRATES OF ASPHALT, CONCRETE, TAR OR OTHER ADHESIVES TO ALLOW ACCESS.
- WHERE A SUMP IS REQUIRED, THE SANDY CITY PUBLIC UTILITIES INSPECTOR SHALL BE CONTACTED PRIOR TO CONSTRUCTION TO PROVIDE AN OPPORTUNITY TO CHECK THE VOLUME OF GRAVEL AND GRAVEL GRADATION.
- SIGNS MUST BE POSTED NEAR EACH INLET BOX LOCATED IN A DRINKING WATER RECHARGE ZONE WITH THE FOLLOWING WORDS "WARNING THIS IS A DRINKING WATER AQUIFER RECHARGE AREA. DISPOSAL OF ANY WASTE MATERIALS IN THE STORM WATER IS STRICTLY PROHIBITED."
- ALL INLET, COMBO AND JUNCTION BOXES SHALL BE PLACED ON A 12-INCH (MIN.) COMPACTED STABILIZATION MATERIAL.
- A VIDEO OF ALL PIPES MUST BE COMPLETED BEFORE THE 80% OR 90% BOND RELEASE AND AGAIN BEFORE FINAL BOND RELEASE.
- A REPRESENTATIVE OF THE MANUFACTURER OR SUPPLIER SHALL BE ON SITE DURING INSTALLATION OF OILWATER SEPARATOR, MECHANICAL TREATMENT DEVICES, MEDICAL FILTERS, AND UNDERGROUND DETENTION/RETENTION SYSTEMS. THE MANUFACTURER OR SUPPLIER SHALL PROVIDE A LETTER STATING THAT THE SYSTEM WAS INSTALLED PER MANUFACTURER'S SPECIFICATIONS. IF IT IS UNKNOWN WHETHER A REPRESENTATIVE IS REQUIRED TO BE PRESENT DURING INSTALLATION, CONTACT THE SAND CITY PUBLIC UTILITIES INSPECTOR.
- A STAMPED "LETTER OF CONFORMANCE" FROM THE DESIGN ENGINEER IS REQUIRED TO BE SUBMITTED TO SANDY CITY PUBLIC UTILITIES DEPARTMENT, PRIOR TO 90% BOND RELEASE, STATING THAT STORM WATER FLOW CONTROL ELEMENTS AND STORM WATER TREATMENT FACILITIES (E.G. DETENTION, RETENTION, LID BEST MANAGEMENT PRACTICES, OILWATER SEPARATORS, PUMPS, ETC.) WERE CONSTRUCTED ACCORDING TO THE APPROVED PLANS.

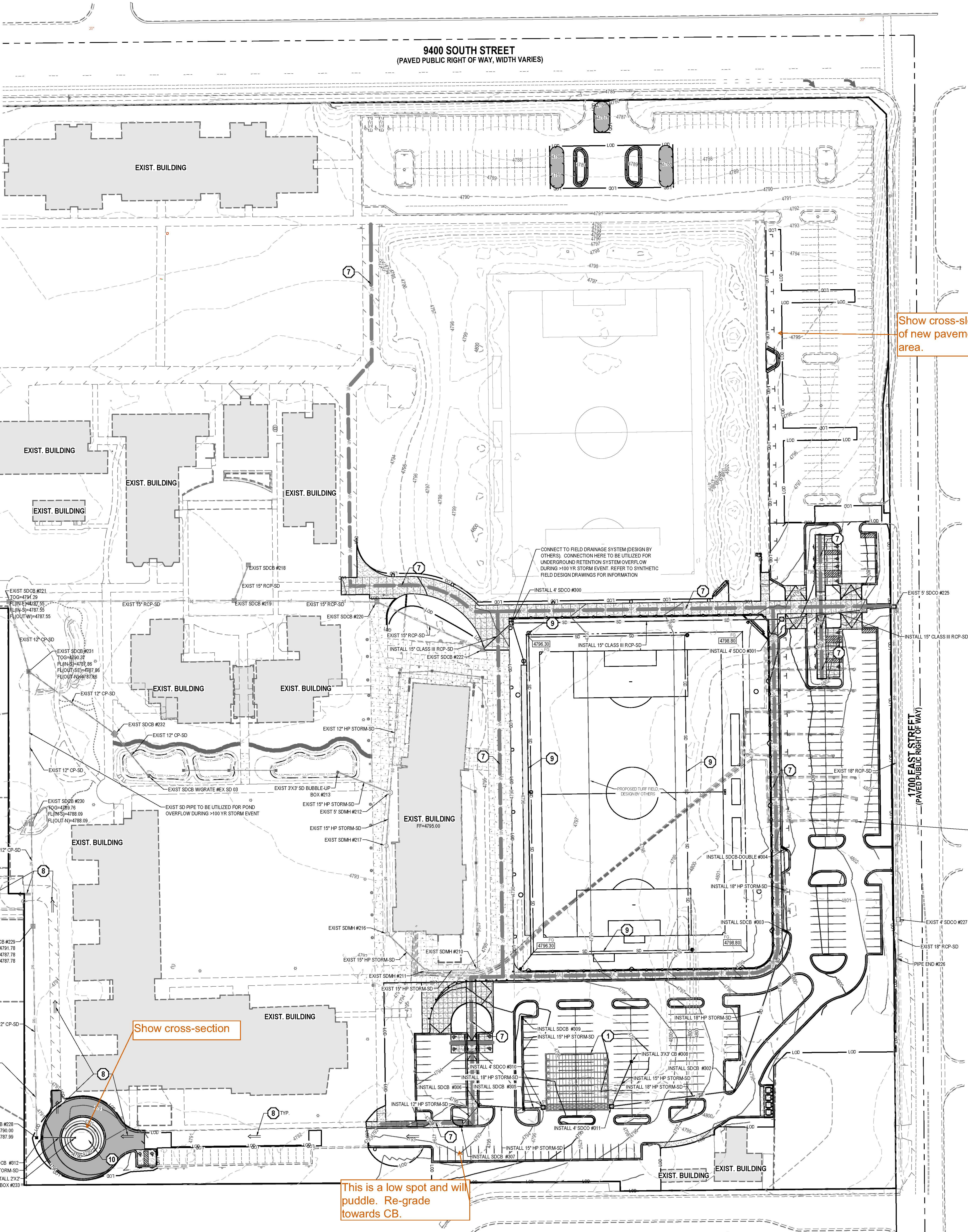

GENERAL NOTES

- ALL WORK TO COMPLY WITH THE GOVERNING AGENCY'S STANDARDS AND SPECIFICATIONS.
- ALL IMPROVEMENTS MUST COMPLY WITH ADA STANDARDS AND RECOMMENDATIONS.
- ALL WORK SHALL COMPLY WITH THE RECOMMENDATIONS OF THE GEOTECHNICAL ENGINEER POSSIBLY INCLUDING, BUT NOT LIMITED TO, REMOVAL OF UNCONSOLIDATED FILL, ORGANICS, AND DEBRIS, PLACEMENT OF SUBSURFACE DRAIN LINES AND GEOTEXTILE, AND OVEREXCAVATION OF UNSUITABLE BEARING MATERIALS AND PLACEMENT OF ACCEPTABLE FILL MATERIAL.
- THE CONTRACTOR SHALL BECOME FAMILIAR WITH THE EXISTING SOIL CONDITIONS.
- LANDSCAPED AREAS REQUIRE SUBGRADE TO BE MAINTAINED AT A SPECIFIC ELEVATION BELOW FINISHED GRADE AND REQUIRE SUBGRADE TO BE PROPERLY PREPARED AND SCARIFIED. SEE LANDSCAPE PLANS FOR ADDITIONAL INFORMATION.
- SLOPE ALL LANDSCAPED AREAS AWAY FROM BUILDING FOUNDATIONS TOWARD CURB AND GUTTER OR STORM DRAIN INLETS.
- EXISTING UNDERGROUND UTILITIES AND IMPROVEMENTS ARE SHOWN IN THEIR APPROXIMATE LOCATIONS BASED UPON RECORD INFORMATION AVAILABLE AT THE TIME OF PREPARATION OF THESE PLANS. LOCATIONS MAY NOT HAVE BEEN VERIFIED IN THE FIELD AND NO GUARANTEE IS MADE AS TO THE ACCURACY OR COMPLETENESS OF THE INFORMATION SHOWN. IT SHALL BE THE RESPONSIBILITY OF THE CONTRACTOR TO DETERMINE THE EXISTENCE AND LOCATION OF THE UTILITIES SHOWN ON THESE PLANS OR INDICATED IN THE FIELD BY LOCATING SERVICES. ANY ADDITIONAL COSTS INCURRED AS A RESULT OF THE CONTRACTOR'S FAILURE TO VERIFY THE LOCATIONS OF EXISTING UTILITIES PRIOR TO THE BEGINNING OF CONSTRUCTION IN THEIR VICINITY SHALL BE BORNE BY THE CONTRACTOR AND ASSUMED INCLUDED IN THE CONTRACT. THE CONTRACTOR IS TO VERIFY ALL CONNECTION POINTS WITH THE EXISTING UTILITIES. THE CONTRACTOR IS RESPONSIBLE FOR ANY DAMAGE CAUSED TO THE EXISTING UTILITIES AND UTILITY STRUCTURES THAT ARE TO REMAIN. IF CONFLICTS WITH EXISTING UTILITIES OCCUR, THE CONTRACTOR SHALL NOTIFY THE ENGINEER PRIOR TO CONSTRUCTION TO DETERMINE IF ANY FIELD ADJUSTMENTS SHOULD BE MADE.
- ALL STORM DRAIN INFRASTRUCTURE TO BE INSTALLED PER GOVERNING AGENCY OR APWA STANDARD PLANS AND SPECIFICATIONS.
- ENSURE MINIMUM COVER OVER ALL STORM DRAIN PIPES PER MANUFACTURER'S RECOMMENDATIONS. NOTIFY ENGINEER IF MINIMUM COVER CANNOT BE ATTAINED.
- ALL FACILITIES WITH DOWNSPOUTS/ROOF DRAINS SHALL BE CONNECTED TO THE STORM DRAIN SYSTEM. SEE PLUMBING PLANS FOR DOWNSPOUT/ROOF DRAIN LOCATIONS AND SIZES. ALL ROOF DRAINS TO HAVE MINIMUM 1% SLOPE.
- THE CONTRACTOR SHALL ADJUST TO GRADE ALL EXISTING UTILITIES AS NEEDED PER LOCAL GOVERNING AGENCY'S STANDARDS AND SPECIFICATIONS.
- THE CONTRACTOR IS TO PROTECT AND PRESERVE ALL EXISTING IMPROVEMENTS, UTILITIES, AND SIGNS, ETC. UNLESS OTHERWISE NOTED ON THESE PLANS.
- THE CONTRACTOR IS TO PROTECT AND PRESERVE ALL EXISTING IMPROVEMENTS, UTILITIES, AND SIGNS, ETC. UNLESS OTHERWISE NOTED ON THESE PLANS.
- STORM DRAIN PIPE NOT CONNECTED TO UNDERGROUND DETENTION FACILITIES SHALL BE RCP CULI STORM DRAIN LINE OR APPROVED EQUAL. INSTALLATION AND TRENCHING PER APWA STANDARDS AND SPECIFICATIONS. LENGTH AND SLOPE PER PLAN.
- CURB AND GUTTER IN LINE CATCH BASINS SHALL BE PER SANDY CITY DETAIL SW-02 AND SPECIFICATIONS UNLESS OTHERWISE NOTED. KNOCKOUT STRUCTURES SHALL HAVE A CONCRETE COLLAR THAT EXTENDS TO THE EDGE OF THE BOX PER SANDY CITY DETAIL SD-06.
- CATCH BASINS NOT IN LINE WITH CURB AND GUTTER SHALL BE 2'X2' INLET BOXES AND SHALL BE INSTALLED PER MANUFACTURER RECOMMENDATIONS. KNOCKOUT STRUCTURES SHALL HAVE A CONCRETE COLLAR THAT EXTENDS TO THE EDGE OF THE BOX PER SANDY CITY DETAIL SD-06.
- COMBINATION INLET/CLEANOUT BOXES SHALL BE PER SANDY CITY DETAIL SW-04A AND SPECIFICATIONS UNLESS OTHERWISE NOTED. KNOCKOUT BOXES SHALL HAVE A CONCRETE COLLAR THAT EXTENDS TO THE EDGE OF THE BOX PER SANDY CITY DETAIL SD-06.
- CLEANOUT BOXES SHALL BE PER SANDY CITY DETAILS SW-05A AND SW-05B AND SPECIFICATIONS UNLESS OTHERWISE NOTED. KNOCKOUT BOXES SHALL HAVE A CONCRETE COLLAR THAT EXTENDS TO THE EDGE OF THE BOX PER SANDY CITY DETAIL SD-06.

SCOPE OF WORK:

PROVIDE, INSTALL AND/OR CONSTRUCT THE FOLLOWING PER THE SPECIFICATIONS GIVEN OR REFERENCED. THE DETAILS NOTED, AND/OR AS SHOWN ON THE CONSTRUCTION DRAWINGS:

- UNDERGROUND RETENTION BASIN  
171 CULTEC RECHARGER 302ND CHAMBERS  
INSTALL PER MANUFACTURER'S RECOMMENDATIONS. SEE DETAILS ON SHEET C-003  
100-YR 24HR VOLUME REQUIRED = 17,782 CF  
LID VOLUME REQUIRED = 1,553 CF  
STORAGE PROVIDED = 18,146 CF  
TOP OF STONE = 4792.25  
TOP OF CHAMBERS = 4791.25  
BOTTOM OF CHAMBERS = 4787.25  
BOTTOM OF STONE = 4788.25
- ADS HP STORM STORM DRAIN PIPE OR APPROVED EQUAL. INSTALLATION AND TRENCHING PER APWA PLANS 381C-601 AND 382C-601 AND SPECIFICATIONS. LENGTH AND SLOPE PER PLAN.
- SDCB: 3'X3' CATCH BASIN WITH 24" SQ. FRAME AND PEDESTALIAN SAFE GRATE. BOX PER SANDY DETAILS SD-05 AND SD-06 AND SPECIFICATIONS. SEE SHEET C-602 FOR DETAILS.
- SDCB: 2'X4' CATCH BASIN WITH 24" SQ. FRAME AND PEDESTALIAN SAFE GRATE. BOX PER SANDY DETAILS SD-05 AND SD-06 AND SPECIFICATIONS. SEE SHEET C-602 FOR DETAILS.
- SDCO: JUNCTION BOX WITH 24" SOLID MANHOLE LID. BOX SIZE PER PLAN AND SANDY DETAILS SD-05 AND SD-06 AND SPECIFICATIONS. SEE SHEET C-602 FOR DETAILS.
- 3H-1V MAX. SLOPE.
- DESIGNATED ACCESSIBLE ROUTE TO PUBLIC WAY. ENSURE GRADES TO NOT EXCEED 5.00% RUNNING SLOPE AND 2.00% CROSS SLOPE. CONTRACTOR WILL BE REQUIRED AT OWN EXPENSE TO REPLACE ANY AREAS WHICH EXCEED THESE SLOPES ALONG THE ACCESSIBLE ROUTE.
- INDICATES OVERLAND FLOW PATH TO THE PUBLIC WAY. ➡
- DRAINAGE SYSTEM FOR SYNTHETIC TURF FIELD SHOWN FOR REFERENCE. DESIGN BY OTHERS. SEE TURF FIELD DESIGN DRAWINGS FOR DETAILED INFORMATION.
- STORM DRAIN INFILTRATION POND  
100-YR 34HR RETENTION STORAGE = 765 CF  
LID VOLUME REQUIRED = 120 CF  
STORAGE PROVIDED = 1,630 CF  
HML = 4790.00  
BOTTOM = 4788.00

EXISTING GEOTHERMAL PIPING EXTENTS SHOWN FOR REFERENCE. SEE GEOTHERMAL DESIGN AS PART OF SCIENCE CENTER CONSTRUCTION PLANS FOR DETAILED INFORMATION.

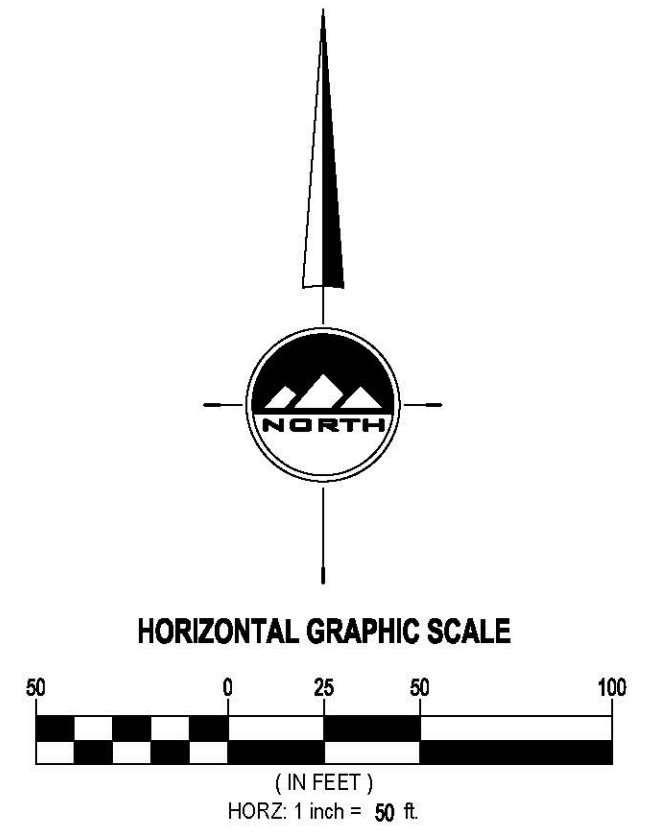

E D A

[A]	The Boston Building 9 Exchange Place, Suite 1100 Salt Lake City, Utah 84111
[C]	801 531 7600
[E]	info@edarch.com
[W]	www.edarch.com

PROJECT ARCHITECT JH  
PROJECT MANAGER KL

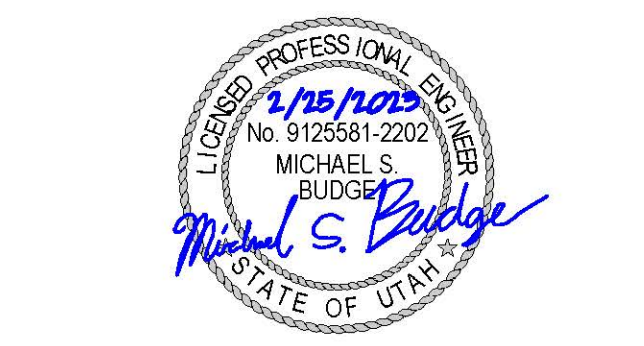

SALT LAKE CITY  
45 W. 10000 S., Suite 500  
Sandy, UT 84070  
Phone: 801.255.0529

WWW.ENSIGNENG.COM  
ENSIGN PROJECT #10651B

WATERFORD SCHOOL  
PARKING ADDITION

1480 E 9400 S  
SANDY, UT 84093

PROJECT NUMBER		
#	DESCRIPTION	DATE
1	SITE PLAN SUBMITTAL	2/28/2023

OVERALL GRADING  
AND DRAINAGE PLAN



GENERAL NOTES

- ALL WORK TO COMPLY WITH THE GOVERNING AGENCY'S STANDARDS AND SPECIFICATIONS.
- ALL IMPROVEMENTS MUST COMPLY WITH ADA STANDARDS AND RECOMMENDATIONS.
- ALL WORK SHALL COMPLY WITH THE RECOMMENDATIONS OF THE GEOTECHNICAL ENGINEER POSSIBLY INCLUDING, BUT NOT LIMITED TO, REMOVAL OF UNCONSOLIDATED FILL, ORGANICS, AND DEBRIS, PLACEMENT OF SUBSURFACE DRAIN LINES AND GEOTEXTILE, AND OVEREXCAVATION OF UNSUITABLE BEARING MATERIALS AND PLACEMENT OF ACCEPTABLE FILL MATERIAL.
- THE CONTRACTOR SHALL BECOME FAMILIAR WITH THE EXISTING SOIL CONDITIONS.
- LANDSCAPED AREAS REQUIRE SUBGRADE TO BE MAINTAINED AT A SPECIFIC ELEVATION BELOW FINISHED GRADE AND REQUIRE SUBGRADE TO BE PROPERLY PREPARED AND SCARIFIED. SEE LANDSCAPE PLANS FOR ADDITIONAL INFORMATION.
- SLOPE ALL LANDSCAPED AREAS AWAY FROM BUILDING FOUNDATIONS TOWARD CURB AND GUTTER OR STORM DRAIN INLETS.
- EXISTING UNDERGROUND UTILITIES AND IMPROVEMENTS ARE SHOWN IN THEIR APPROXIMATE LOCATIONS BASED UPON RECORD INFORMATION AVAILABLE AT THE TIME OF PREPARATION OF THESE PLANS. LOCATIONS MAY NOT HAVE BEEN VERIFIED IN THE FIELD AND NO GUARANTEE IS MADE AS TO THE ACCURACY OR COMPLETENESS OF THE INFORMATION SHOWN. IT SHALL BE THE RESPONSIBILITY OF THE CONTRACTOR TO DETERMINE THE EXISTENCE AND LOCATION OF THE UTILITIES SHOWN ON THESE PLANS OR INDICATED IN THE FIELD BY LOCATING SERVICES. ANY ADDITIONAL COSTS INCURRED AS A RESULT OF THE CONTRACTOR'S FAILURE TO VERIFY THE LOCATIONS OF EXISTING UTILITIES PRIOR TO THE BEGINNING OF CONSTRUCTION IN THEIR VICINITY SHALL BE BORNE BY THE CONTRACTOR AND ASSUMED INCLUDED IN THE CONTRACT. THE CONTRACTOR IS TO VERIFY ALL CONNECTION POINTS WITH THE EXISTING UTILITIES. THE CONTRACTOR IS RESPONSIBLE FOR ANY DAMAGE CAUSED TO THE EXISTING UTILITIES AND UTILITY STRUCTURES THAT ARE TO REMAIN. IF CONFLICTS WITH EXISTING UTILITIES OCCUR, THE CONTRACTOR SHALL NOTIFY THE ENGINEER PRIOR TO CONSTRUCTION TO DETERMINE IF ANY FIELD ADJUSTMENTS SHOULD BE MADE.
- ALL STORM DRAIN INFRASTRUCTURE TO BE INSTALLED PER GOVERNING AGENCY OR APWA STANDARD PLANS AND SPECIFICATIONS.
- ENSURE MINIMUM COVER OVER ALL STORM DRAIN PIPES PER MANUFACTURER'S RECOMMENDATIONS. NOTIFY ENGINEER IF MINIMUM COVER CANNOT BE ATTAINED.

9400 SOUTH STREET  
(PAVED PUBLIC RIGHT OF WAY, WIDTH VARIES)

SANDY CITY STORM WATER NOTES

- NOTIFY SANDY CITY PUBLIC UTILITIES INSPECTOR, 801-568-7280, AT LEAST ONE WORKING DAY (24 HOURS) PRIOR TO BEGINNING ANY CONSTRUCTION.
- A PRE-CONSTRUCTION MEETING IS REQUIRED ONCE FINAL APPROVAL HAS BEEN GRANTED. THE PRE-CONSTRUCTION MEETING SHALL BE SCHEDULED THROUGH SANDY CITY CITY PUBLIC WORKS DEPARTMENT.
- ALL CONSTRUCTION SHALL CONFORM TO THE LATEST REVISION OF THE SANDY CITY STANDARD SPECIFICATIONS AND DETAILS FOR MUNICIPAL CONSTRUCTION AND/OR OTHER REQUIREMENTS AS SET FORTH IN THE PUBLIC UTILITIES FINAL REVIEW AND APPROVAL LETTER ESTABLISHED FOR THE DEVELOPMENT. SPECIFICATIONS AND DETAILS CAN BE OBTAINED ON THE SANDY CITY WEBSITE.
- SUBMITTALS ARE REQUIRED TO BE APPROVED BY THE ENGINEER FOR ALL BEDDING, BACKFILL, PIPE, AND STRUCTURES (INLET BOXES, COMBO BOXES, AND JUNCTION BOXES). SUBMITTALS MUST HAVE SUFFICIENT INFORMATION TO SHOW THAT THE PROPOSED ITEMS CONFORM TO SANDY CITY STANDARDS AND SPECIFICATIONS.
- CONSTRUCTION WORK SHALL BE CONDUCTED IN ACCORDANCE WITH THE UTAH POLLUTION DISCHARGE ELIMINATION SYSTEM (UPDES) REGULATIONS.
- NON-SHRINK GROUT SHALL BE USED WHEREVER GROUT IS REQUIRED FOR THE STORM DRAIN FACILITIES.
- CUT PIPES OFF FLUSH WITH THE INSIDE WALL OF THE BOX OR MANHOLE AND GROUT AT CONNECTION OF PIPE TO BOX AS A SMOOTH FINISH. ADDITIONALLY, ALL JAGGED OR SHARP EDGES AT PIPE CONNECTIONS ARE TO BE REMOVED AND GROUTED SMOOTH.
- GROUT BETWEEN GRADE RINGS. FOR EACH INLET BOX THAT IS LOCATED NEXT TO A CURB, THE CURB AND GUTTER CONTRACTOR IS RESPONSIBLE TO REMOVE ALL PROTRUDING, JAGGED OR SHARP CONCRETE EDGES AND TO GROUT BETWEEN BOTTOM OF INLET LID FRAME AND TOP OF CONCRETE BOX. GROUT TO CREATE A SMOOTH, BEVELED TRANSITION AT ALL EDGES IN CLEAN OUT AND INLET BOXES. GROUT AROUND ALL EDGES OF THE RESTRICTIVE ORIFICE PLATE.
- REMOVE SNAP TIES, NAILS, REBAR AND OTHER PROTRUSIONS FROM THE BOX OR PIPE INSIDE SURFACE, AS WELL AS ALL FOR WORK, PLASTIC AND CARDBOARD.
- SILT AND DEBRIS ARE TO BE CLEANED OUT OF ALL INLET BOXES, COMBO BOXES, JUNCTION BOXES, AND PIPE. THE BOXES AND PIPES ARE TO BE MAINTAINED IN A CLEAN CONDITION UNTIL AFTER THE FINAL BOND RELEASE INSPECTION.
- CLEAN OFF ALL MANHOLE LIDS AND INLET GRATES OF ASPHALT, CONCRETE, TAR OR OTHER ADHESIVES TO ALLOW ACCESS.
- WHERE A SLUMP IS REQUIRED, THE SANDY CITY PUBLIC UTILITIES INSPECTOR SHALL BE CONTACTED PRIOR TO CONSTRUCTION TO PROVIDE AN OPPORTUNITY TO CHECK THE VOLUME OF GRAVEL AND GRAVEL GRADATION.
- SIGNS MUST BE POSTED NEAR EACH INLET BOX LOCATED IN A DRINKING WATER RECHARGE ZONE WITH THE FOLLOWING WORDS "WARNING THIS IS A DRINKING WATER AQUIFER RECHARGE AREA. DISPOSAL OF ANY WASTE MATERIALS IN THE STORM WATER IS STRICTLY PROHIBITED."
- A VIDEO OF ALL PIPES MUST BE COMPLETED BEFORE THE 80% OR 90% BOND RELEASE AND AGAIN BEFORE FINAL BOND RELEASE.
- A REPRESENTATIVE OF THE MANUFACTURER OR SUPPLIER SHALL BE ON SITE DURING INSTALLATION OF OIL/WATER SEPARATOR, MECHANICAL TREATMENT DEVICES, MEDIAL FILTERS, AND UNDERGROUND DETENTION/RETENTION SYSTEMS. THE MANUFACTURER OR SUPPLIER SHALL PROVIDE A LETTER STATING THAT THE SYSTEM WAS INSTALLED PER MANUFACTURER'S SPECIFICATIONS. IF IT IS UNKNOWN WHETHER A REPRESENTATIVE IS REQUIRED TO BE PRESENT DURING INSTALLATION, CONTACT THE SAND CITY PUBLIC UTILITIES INSPECTOR.
- A STAMPED "LETTER OF CONFORMANCE" FROM THE DESIGN ENGINEER IS REQUIRED TO BE SUBMITTED TO SANDY CITY PUBLIC UTILITIES DEPARTMENT, PRIOR TO 90% BOND RELEASE, STATING THAT STORM WATER FLOW CONTROL ELEMENTS AND STORM WATER TREATMENT FACILITIES (E.G. DETENTION, RETENTION, LID BEST MANAGEMENT PRACTICES, OIL/WATER SEPARATORS, SLUMPS, ETC.) WERE CONSTRUCTED ACCORDING TO THE APPROVED PLANS.

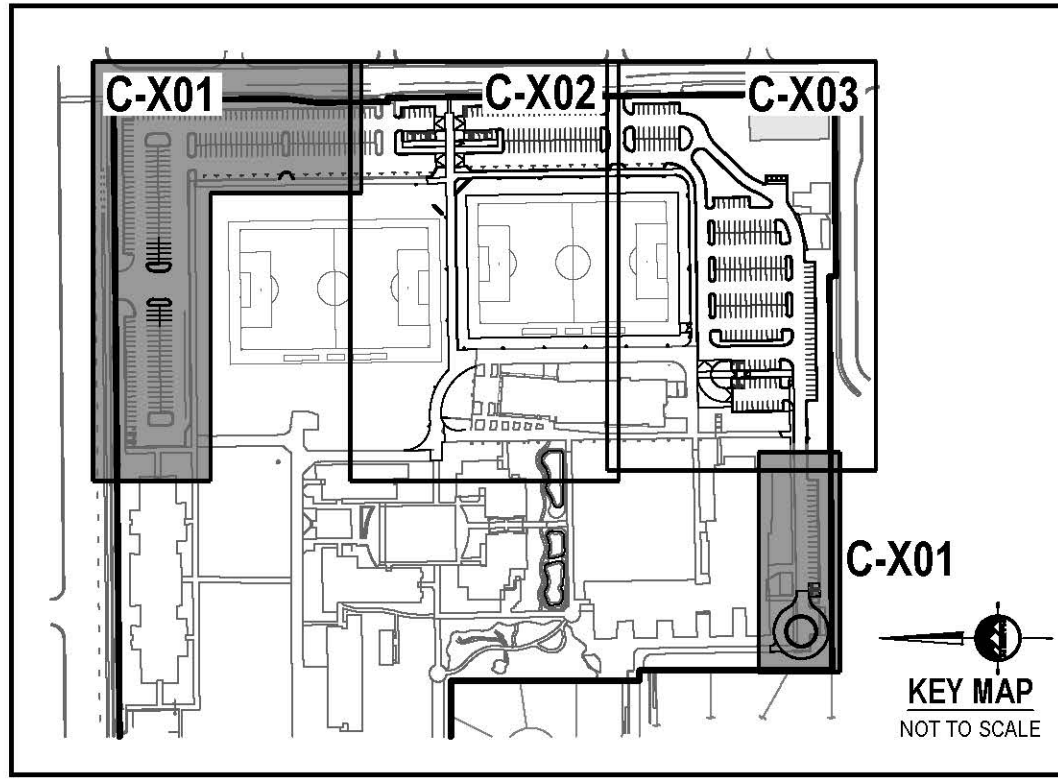
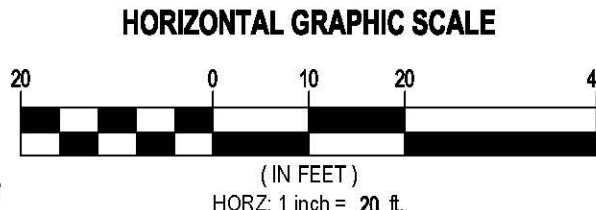
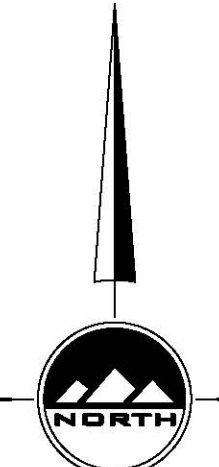

[A]	The Boston Building 9 Exchange Place, Suite 1100 Salt Lake City, Utah 84111
[C]	801 531 7600
[E]	info@edsearch.com
[W]	www.edsearch.com

PROJECT ARCHITECT JH  
PROJECT MANAGER KL

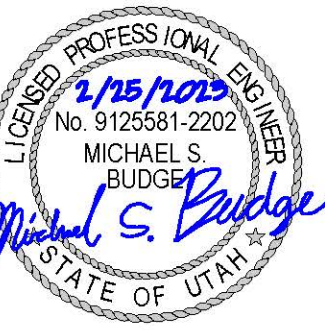

SALT LAKE CITY  
45 W. 10000 S., Suite 500  
Sandy, UT 84070  
Phone: 801.255.0529

WWW.ENSIGNENG.COM  
ENSIGN PROJECT #10651B

WATERFORD SCHOOL  
PARKING ADDITION

1480 E 9400 S  
SANDY, UT 84093

#	DESCRIPTION	DATE
1	SITE PLAN SUBMITTAL	2/28/2023

GRADING AND  
DRAINAGE PLAN

C-301  
2023

© EDA

2/27/2023 9:26:34 AM

SCOPE OF WORK:  
PROVIDE, INSTALL AND/OR CONSTRUCT THE FOLLOWING PER THE SPECIFICATIONS GIVEN OR REFERENCED. THE DETAILS NOTED, AND/OR AS SHOWN ON THE CONSTRUCTION DRAWINGS:

- UNDERGROUND RETENTION BASIN  
171 GALLON RECHARGE WIND CHAMBERS  
INSTALL PER MANUFACTURER'S RECOMMENDATIONS. SEE DETAILS ON SHEET C-303  
100-YR 24-HR VOLUME REQUIRED = 17,762 CF  
LID VOLUME REQUIRED = 1,557 C.F.  
STORAGE PROVIDED = 18,146 CF  
TOP OF CHAMBERS = 4792.25  
BOTTOM OF CHAMBERS = 4787.25  
BOTTOM OF STONE = 4786.25
- ADS HP-STORM STORM DRAIN PIPE OR APPROVED EQUAL. INSTALLATION AND TRENCHING PER APWA PLANS 381C-601 AND 382C-601 AND SPECIFICATIONS. LENGTH AND SLOPE PER PLAN.
- SDCB: 3'x3' CATCH BASIN WITH 24" SQ. FRAME AND PEDESTRIAN SAFE GRATE. BOX PER SANDY DETAILS SD-05 AND SD-06 AND SPECIFICATIONS. SEE SHEET C-302 FOR DETAILS.
- SDCB: 2'x4' CATCH BASIN WITH 24" SQ. FRAME AND PEDESTRIAN SAFE GRATE. BOX PER SANDY DETAILS SD-05 AND SD-06 AND SPECIFICATIONS. SEE SHEET C-302 FOR DETAILS.
- SDCO: JUNCTION BOX WITH 24" SOLID MANHOLE LID. BOX SIZE PER PLAN AND SANDY DETAILS SD-05 AND SD-06 AND SPECIFICATIONS. SEE SHEET C-302 FOR DETAILS.
- 3% MAX. SLOPE

DESIGNATED ACCESSIBLE ROUTE TO PUBLIC WAY. ENSURE GRADES TO NOT EXCEED 5.00% RUNNING SLOPE AND 2.00% CROSS SLOPE. CONTRACTOR WILL BE REQUIRED AT OWN EXPENSE TO REPLACE ANY AREAS WHICH EXCEED THESE SLOPES ALONG THE ACCESSIBLE ROUTE.

INDICATES OVERLAND FLOW PATH TO THE PUBLIC WAY.

DRAINAGE SYSTEM FOR SYNTHETIC TURF FIELD SHOWN FOR REFERENCE. DESIGN BY OTHERS. SEE TURF FIELD DESIGN DRAWINGS FOR DETAILED INFORMATION.

STORM DRAIN INFILTRATION POND  
100-YR 24-HR RETENTION STORAGE = 765 CF  
LID VOLUME REQUIRED = 126 C.F.  
STORAGE PROVIDED = 1,620 CF  
HWL = 4790.00  
BOTTOM = 4788.00

Does this go to Shoshone ave? We need to ensure that this flow will not effect structures. we will need an exhibit and narrative in the drainage report addressing this.

Need to show existing storm drainage system.

Is this going to be a ponding issue? Add some existing grades outside the LOD to show flows will not stop. Typical on all tie in locations for the grading plan.

Missing spot elevation

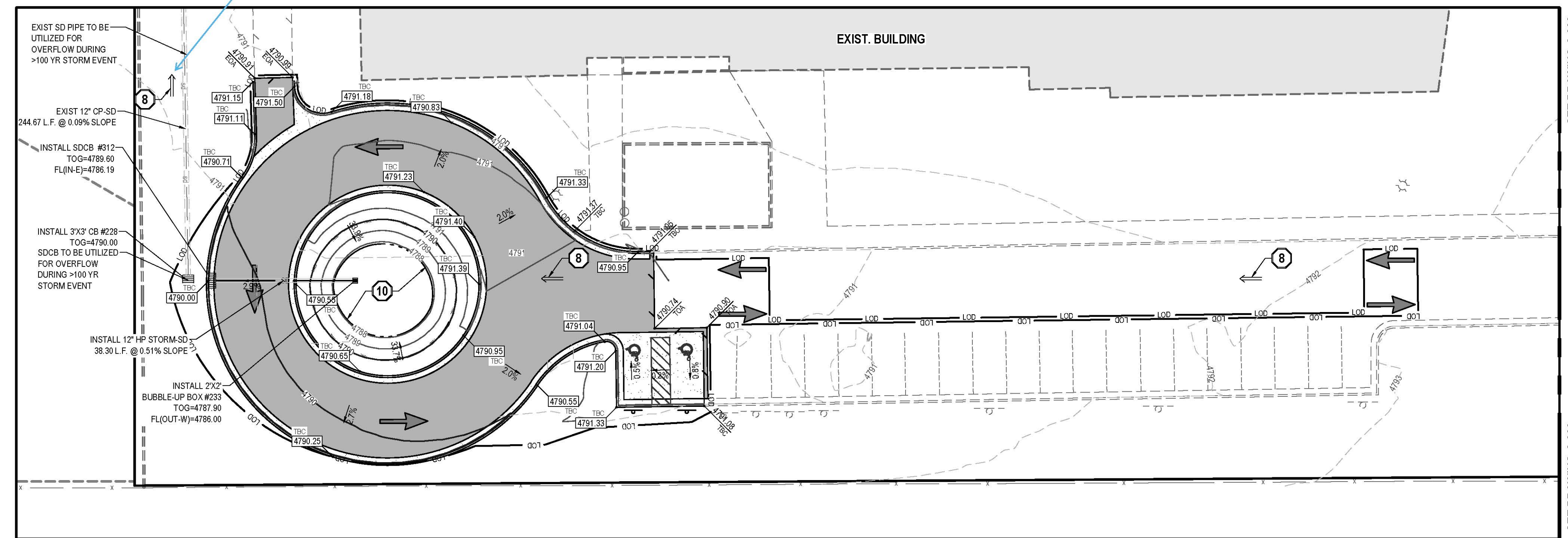

SEE DRAWING C-303

SEE DRAWING C-303

SEE DRAWING C-302

SEE DRAWING C-302



811

CALL BLUESTAKES  
@ 811 AT LEAST 48  
HOURS PRIOR TO THE  
COMMENCEMENT OF  
ANY CONSTRUCTION.  
Keep what's below.  
Call before you dig.

BENCHMARK

NORTH QUARTER CORNER OF  
SECTION 9, TOWNSHIP 3 SOUTH,  
RANGE 1 EAST,  
SALT LAKE BASE AND MERIDIAN  
BM ELEVATION = 4790.40

GENERAL NOTES

- ALL WORK TO COMPLY WITH THE GOVERNING AGENCY'S STANDARDS AND SPECIFICATIONS.
- ALL IMPROVEMENTS MUST COMPLY WITH ADA STANDARDS AND RECOMMENDATIONS.
- ALL WORK SHALL COMPLY WITH THE RECOMMENDATIONS OF THE GEOTECHNICAL ENGINEER POSSIBLY INCLUDING BUT NOT LIMITED TO REMOVAL OF UNCONSOLIDATED FILL, ORGANICS AND DEBRIS, PLACEMENT OF SUBSURFACE DRAIN LINES AND GEOTEXTILE, AND OVEREXCAVATION OF UNSUITABLE BEARING MATERIALS AND PLACEMENT OF ACCEPTABLE FILL MATERIAL.
- THE CONTRACTOR SHALL BECOME FAMILIAR WITH THE EXISTING SOIL CONDITIONS.
- LANDSCAPED AREAS REQUIRE SUBGRADE TO BE MAINTAINED AT A SPECIFIC ELEVATION BELOW FINISHED GRADE AND REQUIRE SUBGRADE TO BE PROPERLY PREPARED AND SCARIFIED. SEE LANDSCAPE PLANS FOR ADDITIONAL INFORMATION.
- SLOPE ALL LANDSCAPED AREAS AWAY FROM BUILDING FOUNDATIONS TOWARD CURB AND GUTTER OR STORM DRAIN INLETS.
- EXISTING UNDERGROUND UTILITIES AND IMPROVEMENTS ARE SHOWN IN THEIR APPROXIMATE LOCATIONS BASED UPON RECORD INFORMATION AVAILABLE AT THE TIME OF PREPARATION OF THESE PLANS. LOCATIONS MAY NOT HAVE BEEN VERIFIED IN THE FIELD AND NO GUARANTEE IS MADE AS TO THE ACCURACY OR COMPLETENESS OF THE INFORMATION SHOWN. IT SHALL BE THE RESPONSIBILITY OF THE CONTRACTOR TO DETERMINE THE EXISTENCE AND LOCATION OF THE UTILITIES SHOWN ON THESE PLANS OR INDICATED IN THE FIELD BY LOCATING SERVICES. ANY ADDITIONAL COSTS INCURRED AS A RESULT OF THE CONTRACTOR'S FAILURE TO VERIFY THE LOCATIONS OF EXISTING UTILITIES PRIOR TO THE BEGINNING OF CONSTRUCTION IN THEIR VICINITY SHALL BE BORNE BY THE CONTRACTOR AND ASSUMED INCLUDED IN THE CONTRACT. THE CONTRACTOR IS TO VERIFY ALL CONNECTION POINTS WITH THE EXISTING UTILITIES. THE CONTRACTOR IS RESPONSIBLE FOR ANY DAMAGE CAUSED TO THE EXISTING UTILITIES AND UTILITY STRUCTURES THAT ARE TO REMAIN. IF CONFLICTS WITH EXISTING UTILITIES OCCUR, THE CONTRACTOR SHALL NOTIFY THE ENGINEER PRIOR TO CONSTRUCTION TO DETERMINE IF ANY FIELD ADJUSTMENTS SHOULD BE MADE.
- ALL STORM DRAIN INFRASTRUCTURE TO BE INSTALLED PER GOVERNING AGENCY OR APWA STANDARD PLANS AND SPECIFICATIONS.

- ENSURE MINIMUM COVER OVER ALL STORM DRAIN PIPES PER MANUFACTURER'S RECOMMENDATIONS. NOTIFY ENGINEER IF MINIMUM COVER CANNOT BE ATTAINED.
- ALL FACILITIES WITH DOWNSPOUTS/ROOF DRAINS SHALL BE CONNECTED TO THE STORM DRAIN SYSTEM. SEE PLUMBING PLANS FOR DOWNSPOUTS/ROOF DRAIN LOCATIONS AND SIZES. ALL ROOF DRAINS TO HAVE MINIMUM 1% SLOPE.
- THE CONTRACTOR SHALL ADJUST TO GRADE ALL EXISTING UTILITIES AS NEEDED PER LOCAL GOVERNING AGENCY'S STANDARDS AND SPECIFICATIONS.
- NOTIFY ENGINEER OF ANY DISCREPANCIES IN DESIGN OR STAKING BEFORE PLACING CONCRETE, ASPHALT, OR STORM DRAIN STRUCTURES OR PIPES.
- THE CONTRACTOR IS TO PROTECT AND PRESERVE ALL EXISTING IMPROVEMENTS, UTILITIES, AND SIGNS, ETC. UNLESS OTHERWISE NOTED ON THESE PLANS.
- STORM DRAIN PIPE NOT CONNECTED TO UNDERGROUND DETENTION FACILITIES SHALL BE RCP CULVI STORM DRAIN LINE OR APPROVED EQUAL. INSTALLATION AND TRENCHING PER APWA STANDARDS AND SPECIFICATIONS. LENGTH AND SLOPE PER PLAN.
- CURB AND GUTTER IN-LINE CATCH BASINS SHALL BE PER SANDY CITY DETAIL SW-02 AND SPECIFICATIONS UNLESS OTHERWISE NOTED. KNOCKOUT STRUCTURES SHALL HAVE A CONCRETE COLLAR THAT EXTENDS TO THE EDGE OF THE BOX PER SANDY CITY DETAIL SD-06.
- CATCH BASINS NOT IN-LINE WITH CURB AND GUTTER SHALL BE 2'X2' INLET BOXES AND SHALL BE INSTALLED PER MANUFACTURER RECOMMENDATIONS. KNOCKOUT STRUCTURES SHALL HAVE A CONCRETE COLLAR THAT EXTENDS TO THE EDGE OF THE BOX PER SANDY CITY DETAIL SD-06.
- COMBINATION INLET/CLEANOUT BOXES SHALL BE PER SANDY CITY DETAIL SW-04A AND SPECIFICATIONS UNLESS OTHERWISE NOTED. KNOCKOUT BOXES SHALL HAVE A CONCRETE COLLAR THAT EXTENDS TO THE EDGE OF THE BOX PER SANDY CITY DETAIL SD-06.
- CLEANOUT BOXES SHALL BE PER SANDY CITY DETAIL SW-05A AND SW-05B AND SPECIFICATIONS UNLESS OTHERWISE NOTED. KNOCKOUT BOXES SHALL HAVE A CONCRETE COLLAR THAT EXTENDS TO THE EDGE OF THE BOX PER SANDY CITY DETAIL SD-06.

SANDY CITY STORM WATER NOTES

- NOTIFY SANDY CITY PUBLIC UTILITIES INSPECTOR, 801-568-7280, AT LEAST ONE WORKING DAY (24 HOURS) PRIOR TO BEGINNING ANY CONSTRUCTION.
- A PRE-CONSTRUCTION MEETING IS REQUIRED ONCE FINAL APPROVAL HAS BEEN GRANTED. THE PRE-CONSTRUCTION MEETING SHALL BE SCHEDULED THROUGH SANDY CITY PUBLIC WORKS DEPARTMENT.
- ALL CONSTRUCTION SHALL CONFORM TO THE LATEST REVISION OF THE SANDY CITY STANDARD SPECIFICATIONS AND DETAILS FOR MUNICIPAL CONSTRUCTION AND/OR OTHER REQUIREMENTS AS SET FORTH IN THE PUBLIC UTILITIES FINAL REVIEW AND APPROVAL LETTER ESTABLISHED FOR THE DEVELOPMENT. SPECIFICATIONS AND DETAILS CAN BE OBTAINED ON THE SANDY CITY WEBSITE.
- SUBMITTALS ARE REQUIRED TO BE APPROVED BY THE ENGINEER FOR ALL BEDDING, BACKFILL, PIPE, AND STRUCTURES (INLET BOXES, COMBO BOXES, AND JUNCTION BOXES). SUBMITTALS MUST HAVE SUFFICIENT INFORMATION TO SHOW THAT THE PROPOSED ITEMS CONFORM TO SANDY CITY STANDARDS AND SPECIFICATIONS.
- CONSTRUCTION WORK SHALL BE CONDUCTED IN ACCORDANCE WITH THE UTAH POLLUTION DISCHARGE ELIMINATION SYSTEM (UPDES) REGULATIONS.
- NON-SHRINK GROUT SHALL BE USED WHEREVER GROUT IS REQUIRED FOR THE STORM DRAIN FACILITIES.
- CUT PIPES OFF FLUSH WITH THE INSIDE WALL OF THE BOX OR MANHOLE AND GROUT AT CONNECTION OF PIPE TO BOX AS A SMOOTH FINISH. ADDITIONALLY, ALL JAGGED OR SHARP EDGES AT PIPE CONNECTIONS ARE TO BE REMOVED AND GROUTED SMOOTH.
- GROUT BETWEEN GRADE RINGS FOR EACH INLET BOX THAT IS LOCATED NEXT TO A CURB. THE CURB AND GUTTER CONTRACTOR IS RESPONSIBLE TO REMOVE ALL PROTRUDING, JAGGED OR SHARP CONCRETE EDGES AND TO GROUT BETWEEN BOTTOM OF INLET LID FRAME AND TOP OF CONCRETE BOX. GROUT TO CREATE A SMOOTH, BEVELED TRANSITION AT ALL EDGES IN CLEAN OUT AND INLET BOXES. GROUT AROUND ALL EDGES OF THE RESTRICTIVE ORIFICE PLATE.
- REMOVE SNAP TIES, NAILS & REBAR AND OTHER PROTRUSIONS FROM THE BOX OR PIPE INSIDE SURFACE, AS WELL AS ALL FOR WORK, PLASTIC AND CARDBOARD.

- SILT AND DEBRIS ARE TO BE CLEANED OUT OF ALL INLET BOXES, COMBO BOXES, JUNCTION BOXES, AND PIPE. THE BOXES AND PIPES ARE TO BE MAINTAINED IN A CLEAN CONDITION UNTIL AFTER THE FINAL BOND RELEASE INSPECTION.
- CLEAN OFF ALL MANHOLE LIDS AND INLET GRATES OF ASPHALT, CONCRETE, TAR OR OTHER ADHESIVES TO ALLOW ACCESS.
- WHERE A SUMP IS REQUIRED, THE SANDY CITY PUBLIC UTILITIES INSPECTOR SHALL BE CONTACTED PRIOR TO CONSTRUCTION TO PROVIDE AN OPPORTUNITY TO CHECK THE VOLUME OF GRAVEL AND GRAVEL GRADATION. SIGNS MUST BE POSTED NEAR EACH INLET BOX LOCATED IN A DRINKING WATER RECHARGE ZONE WITH THE FOLLOWING WORDS "WARNING THIS IS A DRINKING WATER AQUIFER RECHARGE AREA. DISPOSAL OF ANY WASTE MATERIALS IN THE STORM WATER IS STRICTLY PROHIBITED."
- ALL INLET, COMBO AND JUNCTION BOXES SHALL BE PLACED ON A 12-INCH (MIN.) COMPACTED STABILIZATION MATERIAL.
- A VIDEO OF ALL PIPES MUST BE COMPLETED BEFORE THE 80% OR 90% BOND RELEASE AND AGAIN BEFORE FINAL BOND RELEASE.
- A REPRESENTATIVE OF THE MANUFACTURER OR SUPPLIER SHALL BE ON SITE DURING INSTALLATION OF OIL/WATER SEPARATOR, MECHANICAL TREATMENT DEVICES, MEDIAL FILTERS, AND UNDERGROUND DETENTION/RETENTION SYSTEMS. THE MANUFACTURER OR SUPPLIER SHALL PROVIDE A LETTER STATING THAT THE SYSTEM WAS INSTALLED PER MANUFACTURER'S SPECIFICATIONS. IF IT IS UNKNOWN WHETHER A REPRESENTATIVE IS REQUIRED TO BE PRESENT DURING INSTALLATION, CONTACT THE SANDY CITY PUBLIC UTILITIES INSPECTOR.
- A STAMPED "LETTER OF CONFORMANCE" FROM THE DESIGN ENGINEER IS REQUIRED TO BE SUBMITTED TO SANDY CITY PUBLIC UTILITIES DEPARTMENT. PRIOR TO 80% BOND RELEASE, STATING THAT STORM WATER FLOW CONTROL ELEMENTS AND STORM WATER TREATMENT FACILITIES (E.G. DETENTION, RETENTION, LID BEST MANAGEMENT PRACTICES, OIL-WATER SEPARATORS, SUMPS, ETC.) WERE CONSTRUCTED ACCORDING TO THE APPROVED PLANS.

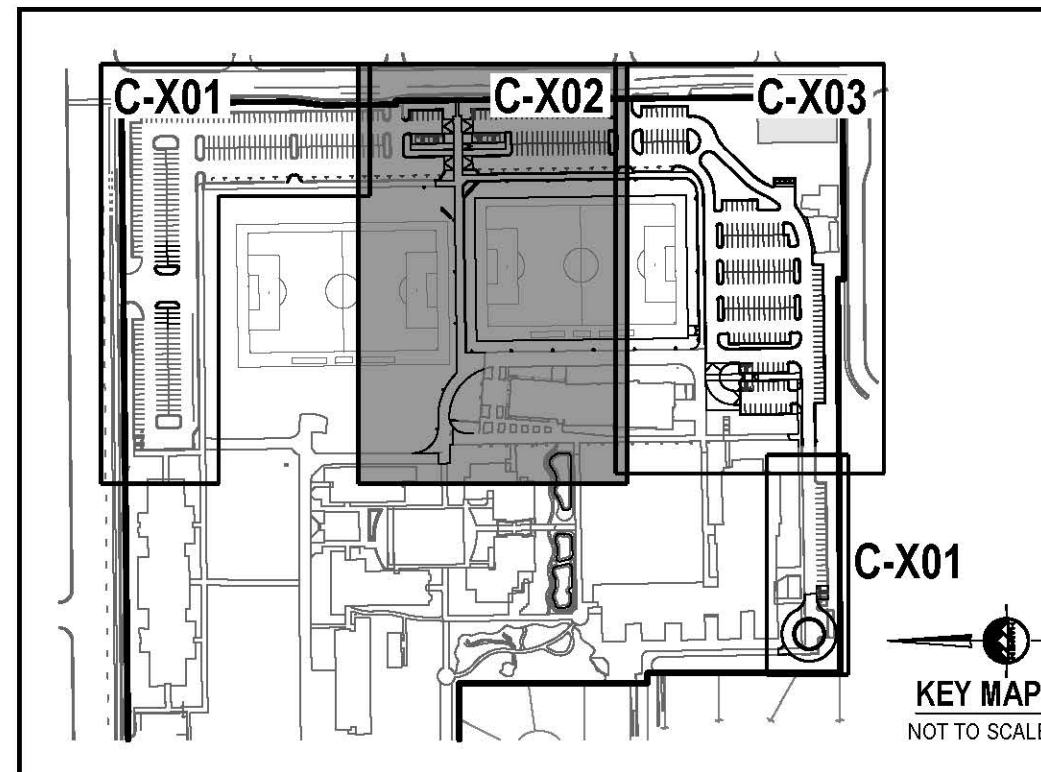
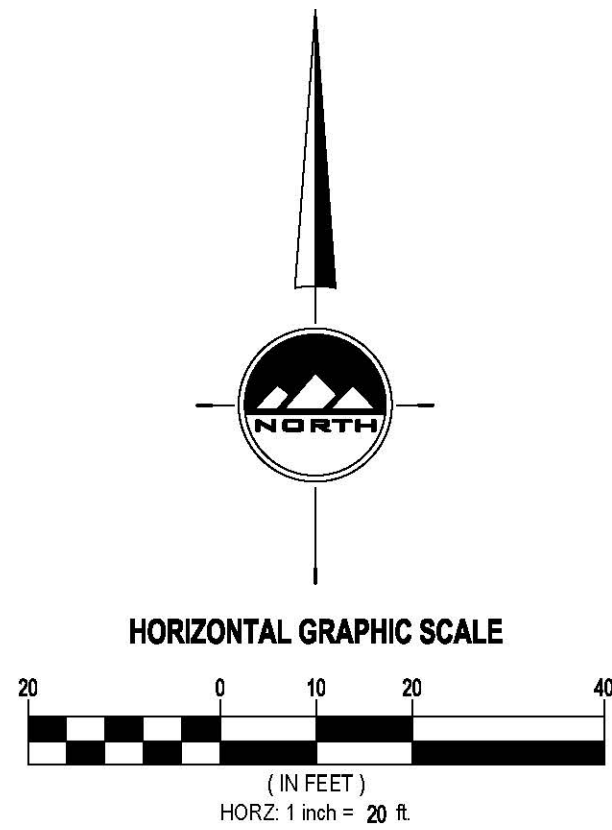

SEE DRAWING C-301

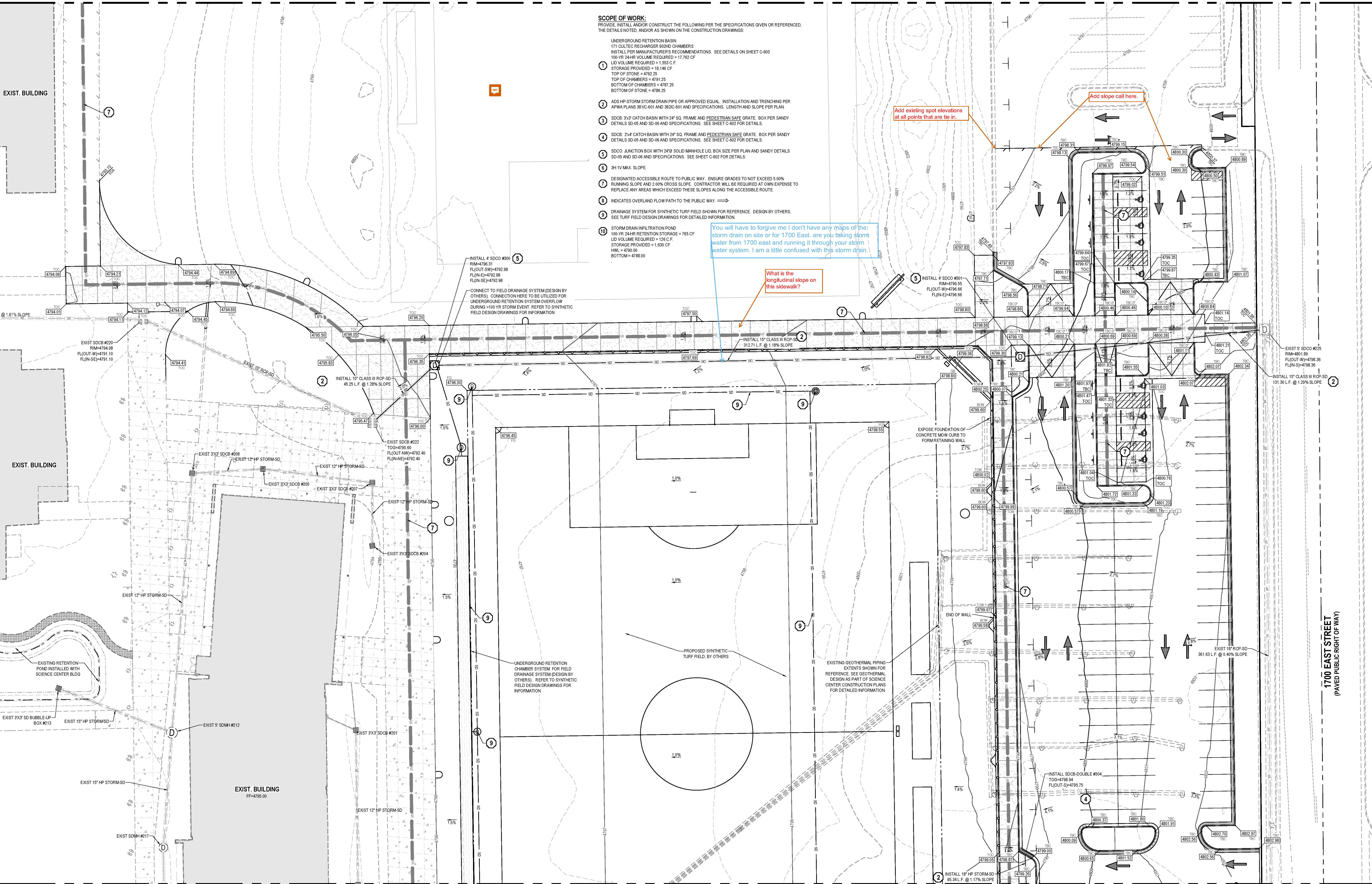

SEE DRAWING C-301

- [A] The Boston Building  
9 Exchange Place, Suite 1100  
Salt Lake City, Utah 84111
- [C] 801.531.7600
- [E] info@edsarch.com
- [W] www.edsarch.com

PROJECT ARCHITECT JH  
PROJECT MANAGER KL



SALT LAKE CITY  
45 W. 10000 S., Suite 500  
Sandy, UT 84070  
Phone: 801.255.0529

WWW.ENSGNENG.COM  
ENSGN PROJECT #10651B

WATERFORD SCHOOL  
PARKING ADDITION

1480 E 9400 S  
SANDY, UT 84093

#	DESCRIPTION	DATE
1	SITE PLAN SUBMITTAL	2/28/2023

GRADING AND  
DRAINAGE PLAN

C-302  
2023

C-EDA

2023/03/03 3:56:46 AM



811

CALL BLUESTAKES  
@ 811 AT LEAST 48  
HOURS PRIOR TO THE  
COMMENCEMENT OF  
ANY CONSTRUCTION.

BENCHMARK

NORTH QUARTER CORNER OF  
SECTION 9, TOWNSHIP 3 SOUTH,  
RANGE 1 EAST  
SALT LAKE BASE AND MERIDIAN  
BM ELEVATION = 4790.40

GENERAL NOTES

- ALL WORK TO COMPLY WITH THE GOVERNING AGENCY'S STANDARDS AND SPECIFICATIONS.
- ALL IMPROVEMENTS MUST COMPLY WITH ADA STANDARDS AND RECOMMENDATIONS.
- ALL WORK SHALL COMPLY WITH THE RECOMMENDATIONS OF THE GEOTECHNICAL ENGINEER POSSIBLY INCLUDING, BUT NOT LIMITED TO, REMOVAL OF UNCONSOLIDATED FILL, ORGANICS, AND DEBRIS, PLACEMENT OF SUBSURFACE DRAIN LINES AND GEOTEXTILE, AND OVEREXCAVATION OF UNSUITABLE BEARING MATERIALS AND PLACEMENT OF ACCEPTABLE FILL MATERIAL.
- THE CONTRACTOR SHALL BECOME FAMILIAR WITH THE EXISTING SOIL CONDITIONS.
- LANDSCAPED AREAS REQUIRE SUBGRADE TO BE MAINTAINED AT A SPECIFIC ELEVATION BELOW FINISHED GRADE AND REQUIRE SUBGRADE TO BE PROPERLY PREPARED AND SCARIFIED. SEE LANDSCAPE PLANS FOR ADDITIONAL INFORMATION.
- SLOPE ALL LANDSCAPED AREAS AWAY FROM BUILDING FOUNDATIONS TOWARD CURB AND GUTTER OR STORM DRAIN INLETS.
- EXISTING UNDERGROUND UTILITIES AND IMPROVEMENTS ARE SHOWN IN THEIR APPROXIMATE LOCATIONS BASED UPON RECORD INFORMATION AVAILABLE AT THE TIME OF PREPARATION OF THESE PLANS. LOCATIONS MAY NOT HAVE BEEN VERIFIED IN THE FIELD AND NO GUARANTEE IS MADE AS TO THE ACCURACY OR COMPLETENESS OF THE INFORMATION SHOWN. IT SHALL BE THE RESPONSIBILITY OF THE CONTRACTOR TO DETERMINE THE EXISTENCE AND LOCATION OF THE UTILITIES SHOWN ON THESE PLANS OR INDICATED IN THE FIELD BY LOCATING SERVICES. ANY ADDITIONAL COSTS INCURRED AS A RESULT OF THE CONTRACTOR'S FAILURE TO VERIFY THE LOCATIONS OF EXISTING UTILITIES PRIOR TO THE BEGINNING OF CONSTRUCTION IN THEIR OWNITY SHALL BE BORNE BY THE CONTRACTOR AND ASSUMED INCLUDED IN THE CONTRACT. THE CONTRACTOR IS TO VERIFY ALL CONNECTION POINTS WITH THE EXISTING UTILITIES. THE CONTRACTOR IS RESPONSIBLE FOR ANY DAMAGE CAUSED TO THE EXISTING UTILITIES AND UTILITY STRUCTURES THAT ARE TO REMAIN. IF CONFLICTS WITH EXISTING UTILITIES OCCUR, THE CONTRACTOR SHALL NOTIFY THE ENGINEER PRIOR TO CONSTRUCTION TO DETERMINE IF ANY FIELD ADJUSTMENTS SHOULD BE MADE.
- ALL STORM DRAIN INFRASTRUCTURE TO BE INSTALLED PER GOVERNING AGENCY OR APWA STANDARD PLANS AND SPECIFICATIONS.

- ENSURE MINIMUM COVER OVER ALL STORM DRAIN PIPES PER MANUFACTURER'S RECOMMENDATIONS. NOTIFY ENGINEER IF MINIMUM COVER CANNOT BE ATTAINED.
- ALL FACILITIES WITH DOWNSPOUTS/ROOF DRAINS SHALL BE CONNECTED TO THE STORM DRAIN SYSTEM. SEE PLUMBING PLANS FOR DOWNSPOUTS/ROOF DRAIN LOCATIONS AND SIZES. ALL ROOF DRAINS TO HAVE MINIMUM 1% SLOPE.
- THE CONTRACTOR SHALL ADJUST TO GRADE ALL EXISTING UTILITIES AS NEEDED PER LOCAL GOVERNING AGENCY'S STANDARDS AND SPECIFICATIONS.
- NOTIFY ENGINEER OF ANY DISCREPANCIES IN DESIGN OR STAKING BEFORE PLACING CONCRETE, ASPHALT, OR STORM DRAIN STRUCTURES OR PIPES.
- THE CONTRACTOR IS TO PROTECT AND PRESERVE ALL EXISTING IMPROVEMENTS, UTILITIES, AND SIGNS, ETC. UNLESS OTHERWISE NOTED ON THESE PLANS.
- STORM DRAIN PIPE NOT CONNECTED TO UNDERGROUND DETENTION FACILITIES SHALL BE RCP CLIII STORM DRAIN LINE OR APPROVED EQUAL. INSTALLATION AND TRENCHING PER APWA STANDARDS AND SPECIFICATIONS. LENGTH AND SLOPE PER PLAN.
- CURB AND GUTTER INLINE CATCH BASINS SHALL BE PER SANDY CITY DETAIL SW-02 AND SPECIFICATIONS UNLESS OTHERWISE NOTED. KNOCKOUT STRUCTURES SHALL HAVE A CONCRETE COLLAR THAT EXTENDS TO THE EDGE OF THE BOX PER SANDY CITY DETAIL SD-06.
- CATCH BASINS NOT IN LINE WITH CURB AND GUTTER SHALL BE 2'X2' INLET BOXES AND SHALL BE INSTALLED PER MANUFACTURER RECOMMENDATIONS. KNOCKOUT STRUCTURES SHALL HAVE A CONCRETE COLLAR THAT EXTENDS TO THE EDGE OF THE BOX PER SANDY CITY DETAIL SD-06.
- COMBINATION INLETS/CLEANOUT BOXES SHALL BE PER SANDY CITY DETAIL SW-04A AND SPECIFICATIONS UNLESS OTHERWISE NOTED. KNOCKOUT BOXES SHALL HAVE A CONCRETE COLLAR THAT EXTENDS TO THE EDGE OF THE BOX PER SANDY CITY DETAIL SD-06.
- CLEANOUT BOXES SHALL BE PER SANDY CITY DETAILS SW-05A AND SW-05B AND SPECIFICATIONS UNLESS OTHERWISE NOTED. KNOCKOUT BOXES SHALL HAVE A CONCRETE COLLAR THAT EXTENDS TO THE EDGE OF THE BOX PER SANDY CITY DETAIL SD-06.

SANDY CITY STORM WATER NOTES

- NOTIFY SANDY CITY PUBLIC UTILITIES INSPECTOR, 801-568-7280, AT LEAST ONE WORKING DAY (24 HOURS) PRIOR TO BEGINNING ANY CONSTRUCTION.
- A PRE-CONSTRUCTION MEETING IS REQUIRED ONCE FINAL APPROVAL HAS BEEN GRANTED. THE PRE-CONSTRUCTION MEETING SHALL BE SCHEDULED THROUGH SANDY CITY CITY PUBLIC WORKS DEPARTMENT.
- ALL CONSTRUCTION SHALL CONFORM TO THE LATEST REVISION OF THE SANDY CITY STANDARD SPECIFICATIONS AND DETAILS FOR MUNICIPAL CONSTRUCTION AND/OR OTHER REQUIREMENTS AS SET FORTH IN THE PUBLIC UTILITIES FINAL REVIEW AND APPROVAL LETTER ESTABLISHED FOR THE DEVELOPMENT. SPECIFICATIONS AND DETAILS CAN BE OBTAINED ON THE SANDY CITY WEBSITE.
- SUBMITTALS ARE REQUIRED TO BE APPROVED BY THE ENGINEER FOR ALL BEDDING, BACKFILL, PIPE, AND STRUCTURES (INLET BOXES, COMBO BOXES, AND JUNCTION BOXES). SUBMITTALS MUST HAVE SUFFICIENT INFORMATION TO SHOW THAT THE PROPOSED ITEMS CONFORM TO SANDY CITY STANDARDS AND SPECIFICATIONS.
- CONSTRUCTION WORK SHALL BE CONDUCTED IN ACCORDANCE WITH THE UTAH POLLUTION DISCHARGE ELIMINATION SYSTEM (UPDES) REGULATIONS.
- NON-SHRINK GROUT SHALL BE USED WHEREVER GROUT IS REQUIRED FOR THE STORM DRAIN FACILITIES.
- CUT PIPES OFF FLUSH WITH THE INSIDE WALL OF THE BOX OR MANHOLE AND GROUT AT CONNECTION OF PIPE TO BOX AS A SMOOTH FINISH. ADDITIONALLY, ALL JAGGED OR SHARP EDGES AT PIPE CONNECTIONS ARE TO BE REMOVED AND GROUTED SMOOTH.
- GROUT BETWEEN GRADE RINGS FOR EACH INLET BOX THAT IS LOCATED NEXT TO A CURB, THE CURB AND GUTTER CONTRACTOR IS RESPONSIBLE TO REMOVE ALL PROTRUDING, JAGGED OR SHARP CONCRETE EDGES AND TO GROUT BETWEEN BOTTOM OF INLET LID FRAME AND TOP OF CONCRETE BOX. GROUT TO CREATE A SMOOTH BEVELED TRANSITION AT ALL EDGES IN CLEAN OUT AND INLET BOXES. GROUT AROUND ALL EDGES OF THE RESTRICTIVE CRIBICE PLATE.
- REMOVE SNAP TIES, NAILS, REBAR AND OTHER PROTRUSIONS FROM THE BOX OR PIPE INSIDE SURFACE, AS WELL AS ALL FOR WORK, PLASTIC AND CARDBOARD.

- SILT AND DEBRIS ARE TO BE CLEANED OUT OF ALL INLET BOXES, COMBO BOXES, JUNCTION BOXES, AND PIPE. THE BOXES AND PIPES ARE TO BE MAINTAINED IN A CLEAN CONDITION UNTIL AFTER THE FINAL BOND RELEASE INSPECTION.
- CLEAN OFF ALL MANHOLE LIDS AND INLET GRATES OF ASPHALT, CONCRETE, TAR OR OTHER ADHESIVES TO ALLOW ACCESS.
- WHERE A SUMP IS REQUIRED, THE SANDY CITY PUBLIC UTILITIES INSPECTOR SHALL BE CONTACTED PRIOR TO CONSTRUCTION TO PROVIDE AN OPPORTUNITY TO CHECK THE VOLUME OF GRAVEL AND GRAVEL GRADATION.
- SIGNS MUST BE POSTED NEAR EACH INLET BOX LOCATED IN A DRINKING WATER RECHARGE ZONE WITH THE FOLLOWING WORDS: "WARNING THIS IS A DRINKING WATER AQUIFER RECHARGE AREA. DISPOSAL OF ANY WASTE MATERIALS IN THE STORM WATER IS STRICTLY PROHIBITED."
- ALL INLET, COMBO AND JUNCTION BOXES SHALL BE PLACED ON A 12-INCH (MIN.) COMPACTED STABILIZATION MATERIAL.
- A VIDEO OF ALL PIPES MUST BE COMPLETED BEFORE THE 80% OR 90% BOND RELEASE AND AGAIN BEFORE FINAL BOND RELEASE.
- A REPRESENTATIVE OF THE MANUFACTURER OR SUPPLIER SHALL BE ON SITE DURING INSTALLATION OF OIL/WATER SEPARATOR, MECHANICAL TREATMENT DEVICES, MEDIAL FILTERS, AND UNDERGROUND DETENTION/RETENTION SYSTEMS. THE MANUFACTURER OR SUPPLIER SHALL PROVIDE A LETTER STATING THAT THE SYSTEM WAS INSTALLED PER MANUFACTURER'S SPECIFICATIONS. IF IT IS UNKNOWN WHETHER A REPRESENTATIVE IS REQUIRED TO BE PRESENT DURING INSTALLATION, CONTACT THE SANDY CITY PUBLIC UTILITIES INSPECTOR.
- A STAMPED "LETTER OF CONFORMANCE" FROM THE DESIGN ENGINEER IS REQUIRED TO BE SUBMITTED TO SANDY CITY PUBLIC UTILITIES DEPARTMENT PRIOR TO 90% BOND RELEASE, STATING THAT STORM WATER FLOW CONTROL ELEMENTS AND STORM WATER TREATMENT FACILITIES (E.G. DETENTION, RETENTION, LID BEST MANAGEMENT PRACTICES, OIL-WATER SEPARATORS, SUMPS, ETC.) WERE CONSTRUCTED ACCORDING TO THE APPROVED PLANS.

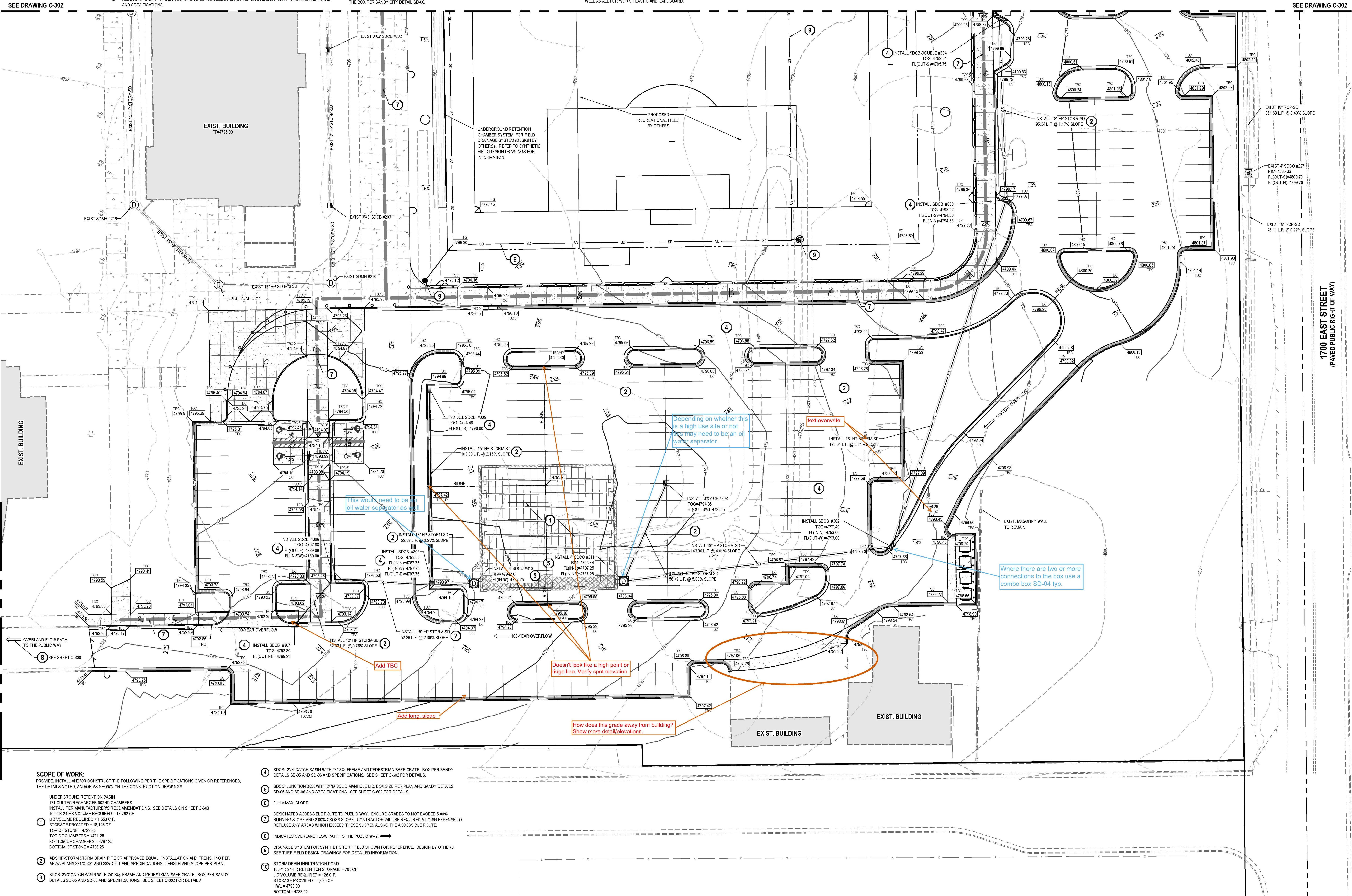
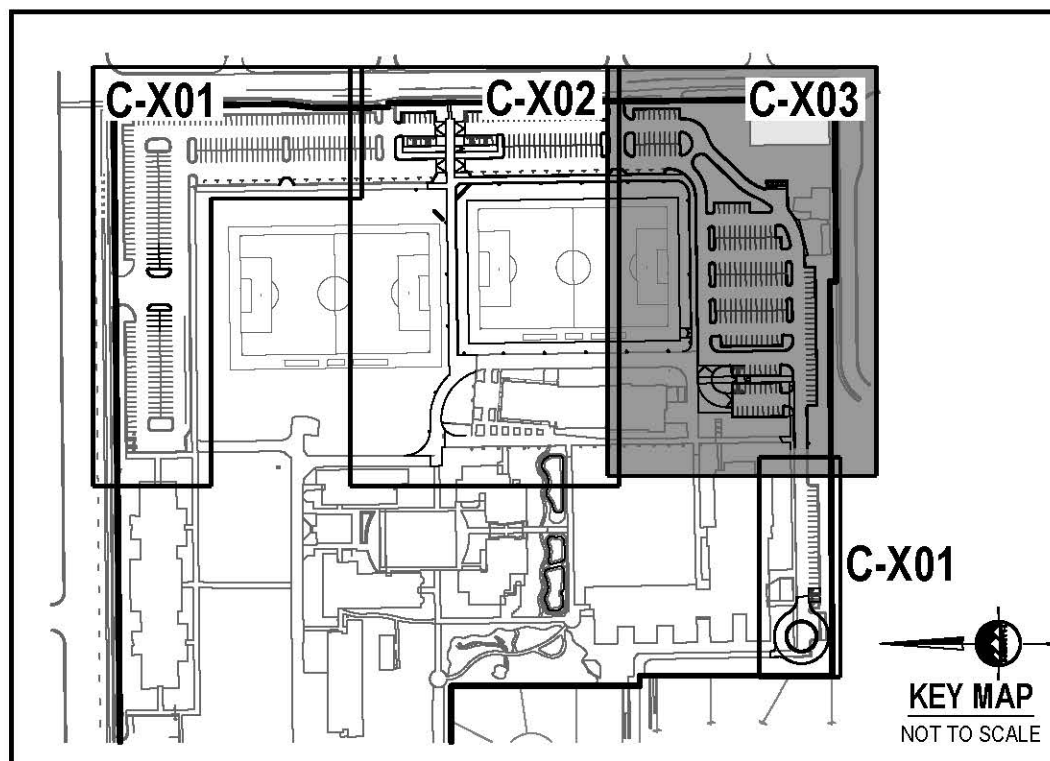
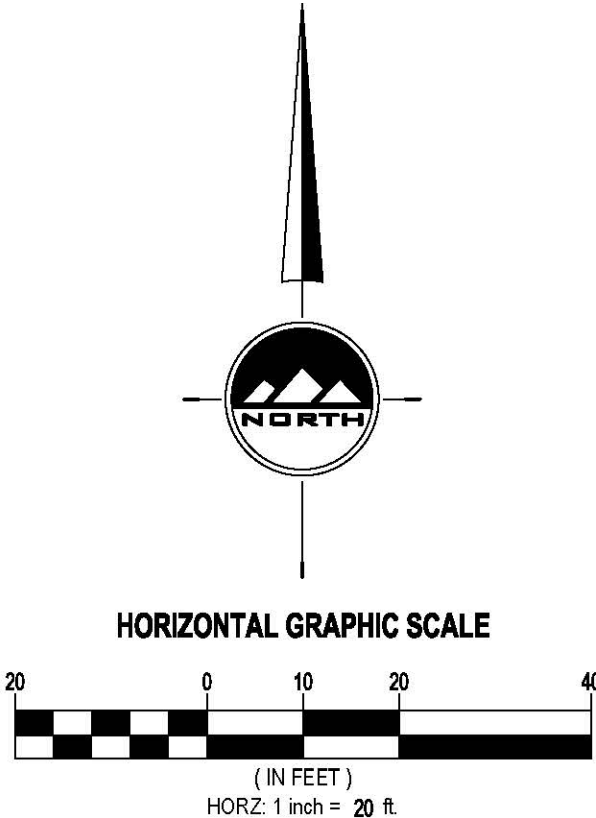

- [A] The Boston Building  
9 Exchange Place, Suite 1100  
Salt Lake City, Utah 84111
- [C] 801 531 7600
- [E] info@edarch.com
- [W] www.edarch.com

PROJECT ARCHITECT  
PROJECT MANAGER

JH  
KL



SALT LAKE CITY  
45 W. 10000 S., Suite 500  
Sandy, UT 84070  
Phone: 801.255.0529

WWW.ENSIGNENG.COM  
ENSIGN PROJECT #10651B

WATERFORD SCHOOL  
PARKING ADDITION

1480 E 9400 S  
SANDY, UT 84093

#	DESCRIPTION	DATE
1	SITE PLAN SUBMITTAL	2/28/2023

GRADING AND  
DRAINAGE PLAN

C-303

2023

CEDA

20230203 8:57:04 AM



811

CALL BLUESTAKES  
@ 811 AT LEAST 48  
HOURS PRIOR TO THE  
COMMENCEMENT OF  
ANY CONSTRUCTION.  
*Know what's below.  
Call before you dig.*

BENCHMARK

NORTH QUARTER CORNER OF  
SECTION 9, TOWNSHIP 3 SOUTH,  
RANGE 1 EAST  
SALT LAKE BASE AND MERIDIAN  
BM ELEVATION = 4790.40

GENERAL NOTES

1. ALL WORK TO COMPLY WITH THE GOVERNING AGENCY'S STANDARDS AND SPECIFICATIONS.

2. ALL IMPROVEMENTS MUST COMPLY WITH ADA STANDARDS AND RECOMMENDATIONS.

3. SEE LANDSCAPE/ARCHITECTURAL PLANS FOR CONCRETE MATERIAL, COLOR, FINISH, AND SCORE PATTERNS THROUGHOUT SITE.

4. ALL PAVEMENT MARKINGS SHALL CONFORM TO THE LATEST EDITION OF THE M.U.T.C.D. (MANUAL ON UNIFORM TRAFFIC CONTROL DEVICES).

5. ALL SURFACE IMPROVEMENTS DISTURBED BY CONSTRUCTION SHALL BE RESTORED OR REPLACED, INCLUDING TREES AND DECORATIVE SHRUBS, SOD, FENCES, WALLS AND STRUCTURES, WHETHER OR NOT THEY ARE SPECIFICALLY SHOWN ON THE CONTRACT DOCUMENTS.

6. NOTIFY ENGINEER OF ANY DISCREPANCIES IN DESIGN OR STAKING BEFORE PLACING CONCRETE OR ASPHALT.

7. THE CONTRACTOR IS TO PROTECT AND PRESERVE ALL EXISTING IMPROVEMENTS, UTILITIES, AND SIGNS, ETC. UNLESS OTHERWISE NOTED ON THESE PLANS.

SEE ARCHITECTURAL DRAWING A001 FOR PROJECT LIMITS.

SCOPE OF WORK:

PROVIDE, INSTALL AND/OR CONSTRUCT THE FOLLOWING PER THE SPECIFICATIONS GIVEN OR REFERENCED, THE DETAILS NOTED, AND/OR AS SHOWN ON THE CONSTRUCTION DRAWINGS.

1. CONCRETE SIDEWALK PER APWA PLAN 231 AND SPECIFICATIONS. SAWCUT JOINTS AND COLOR PER LANDSCAPE PLANS.

2. CONCRETE PAVEMENT PER DETAIL 10C-600. JOINTS TO BE INSTALLED PER APWA PLAN 261.3(C)-601 AND SPECIFICATIONS. CONSTRUCTION JOINT SPACING NOT TO EXCEED 100'.

3. ASPHALT PAVEMENT PER DETAIL 71C-600.

4. TRANSITION BETWEEN COLLECTION CURB AND GUTTER AND REVERSE PAN CURB AND GUTTER.

5. 24" COLLECTION CURB AND GUTTER PER DETAIL 90C-600.

6. 24" REVERSE PAN CURB AND GUTTER PER DETAIL 100C-600.

7. 4" WIDE SOLID WHITE PAVEMENT MARKING PER M.U.T.C.D. STANDARD PLANS.

8. "HANDICAP PARKING" SIGN PER M.U.T.C.D. STANDARD PLANS.

9. PAINTED ADA SYMBOL AND ASSOCIATED HATCHING PER M.U.T.C.D. STANDARD PLANS.

10. SITE LIGHTING SHOWN FOR REFERENCE. SEE PHOTOMETRIC PLANS FOR DESIGN AND FINAL LAYOUT.

11. SEE SHEET C-204 FOR FIRE ROUTE.

12. "END OF FIRE APPARATUS ACCESS ROAD" SIGN PER DETAIL 81C-600.

13. 4 FOOT HIGH ORNAMENTAL FENCE PER LANDSCAPE PLANS.

14. INSTALL FENCE GATE.

15. ASPHALT PAVEMENT EDGE.

16. 8" CONCRETE WATERWAY PER SANDY CITY STANDARD DRAWING OG-03.

17. 6" TYPE 1P" CURB WALL PER APWA STANDARD PLAN 209.

18. HANDICAP ACCESS RAMP PER APWA STANDARD PLAN 235 WITH DETECTABLE WARNING SURFACE PER APWA STANDARD PLAN 238.

19. REMOVABLE BOLLARD.

20. TYPE "K" CURB AND GUTTER WITH 0" CURB FACE SIMILAR TO APWA STANDARD PLAN 205.

21. SANDY CITY RESIDENTIAL STREET LIGHT SHOWN FOR REFERENCE. SEE PHOTOMETRIC PLANS FOR DESIGN AND FINAL LAYOUT.

22. PAINTED LANE-USE ARROWS PER M.U.T.C.D. STANDARD PLANS.

23. TRASH ENCLOSURE PER ARCHITECTURAL PLANS WITH 6" THICK CONCRETE APRON WITH #4 REBAR @ 24" O.C. E.W. ON 6" GRAVEL BASE.

24. 18" CONCRETE MOW CURB.

25. 4" WATERWAY PER APWA STANDARD PLAN NO. 211.

26. 20'x60' SIGHT TRIANGLE.

NORTH

HORIZONTAL GRAPHIC SCALE

20 0 10 20 40

(IN FEET)

HORIZ. 1 inch = 20 ft.

C-X01

C-X02

C-X03

C-X01

KEY MAP

NOT TO SCALE

[A] The Boston Building  
9 Exchange Place, Suite 1100  
Salt Lake City, Utah 84111

[C] 801 531 7600

[E] info@edsarch.com

[W] www.edsearch.com

PROJECT ARCHITECT JH  
PROJECT MANAGER KL

**SALT LAKE CITY**  
45 W. 10000 S., Suite 500  
Sandy, UT 84070  
Phone: 801.255.0529

[www.ensigneng.com](http://www.ensigneng.com)  
ENSIGN PROJECT #10651B

**WATERFORD SCHOOL  
PARKING ADDITION**

1480 E 9400 S  
SANDY, UT 84093

PROJECT NUMBER		
#	DESCRIPTION	DATE
1	SITE PLAN SUBMITTAL	2/28/2023

SITE PLAN

C-202

2023

C)EDA

2/28/2023 1:57:45 PM

SEE DRAWING C-201

EXIST. BUILDING

EXIST. BUILDING

EXIST. BUILDING

SEE DRAWING C-203

SEE DRAWING C-203

I don't see a need to paint these arrows. However, they can be kept if desired. Painting them would require more maintenance.

Show width

Show access width

1700 EAST STREET  
(PAVED PUBLIC RIGHT OF WAY)